

TYPOLOGIES

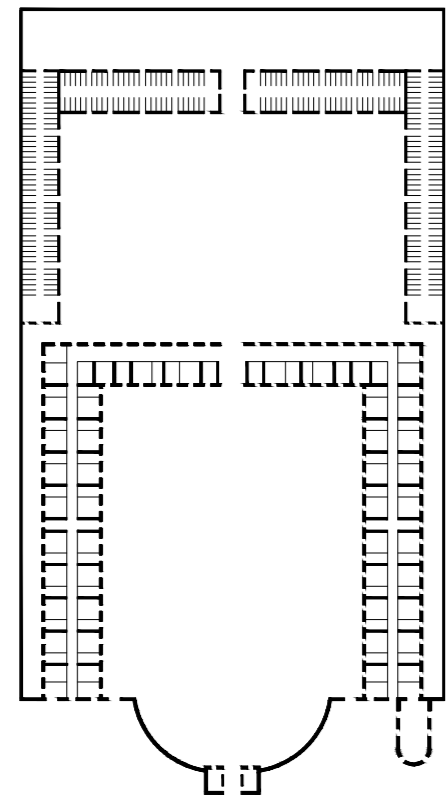

Caserne
Robert de Cotte, Jean Beausire
Caserne des Mousquetaires-Noirs
1699, Paris

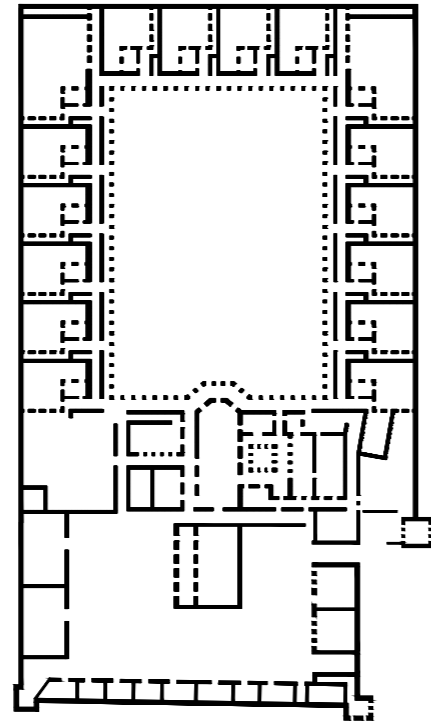

Couvent
Chartreuse de Port Sainte-Marie
1729, Port Sainte-Marie

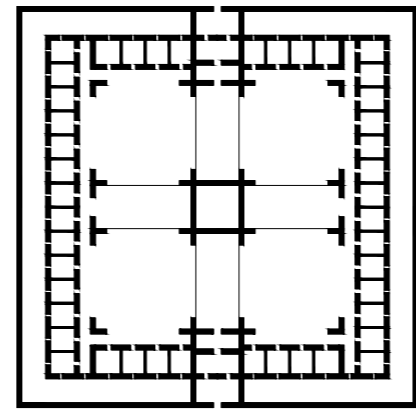

Prison
Claude Nicolas Ledoux
Projet de prison
1786, Aix en Provence

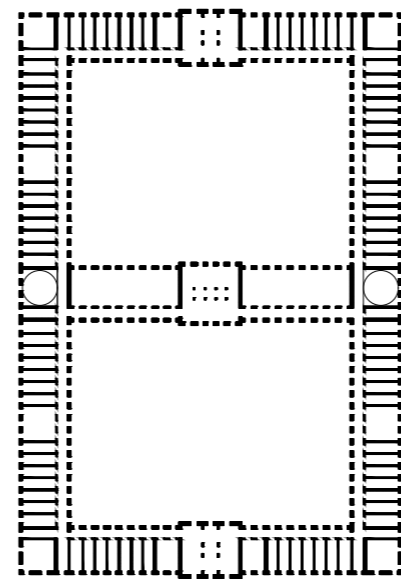

Hospice
Henri Paroës
Hospice Pacheco
1824, Bruxelles

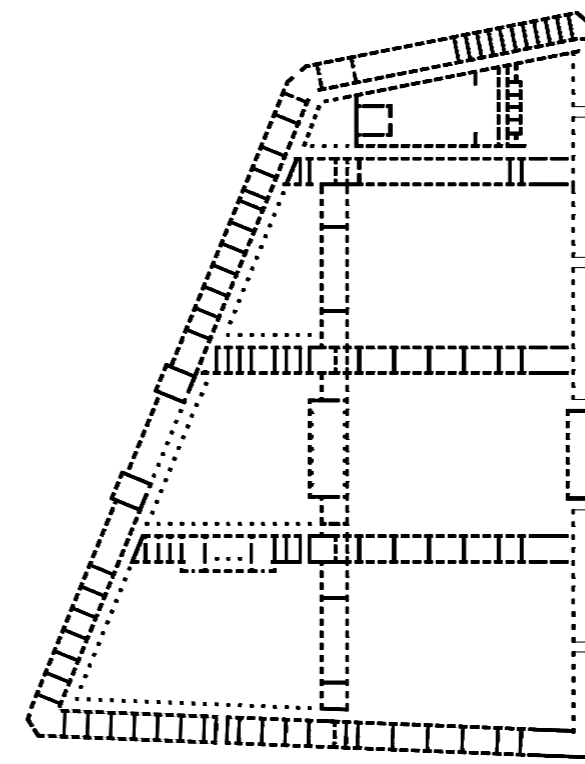

École
Émile Vaudremer
Lycée Champollion
1887, Grenoble

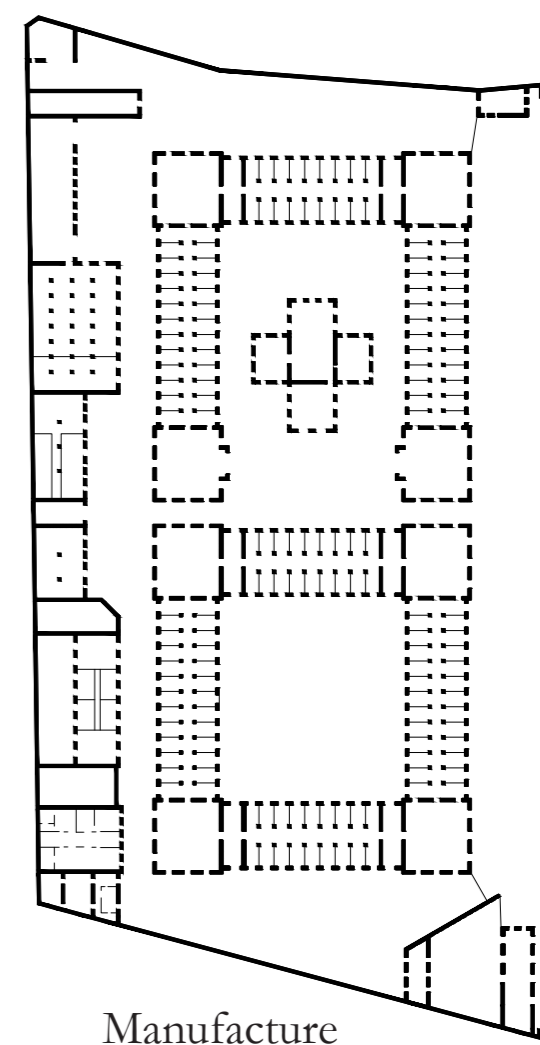

Manufacture
Joseph Clugnet
Manufacture des tabacs
1899, Lyon

PATRIMOINE ENCLAVÉ Pourquoi est-il jugé obsolète ?

CARACTÉRISTIQUES TYPOLOGIQUES

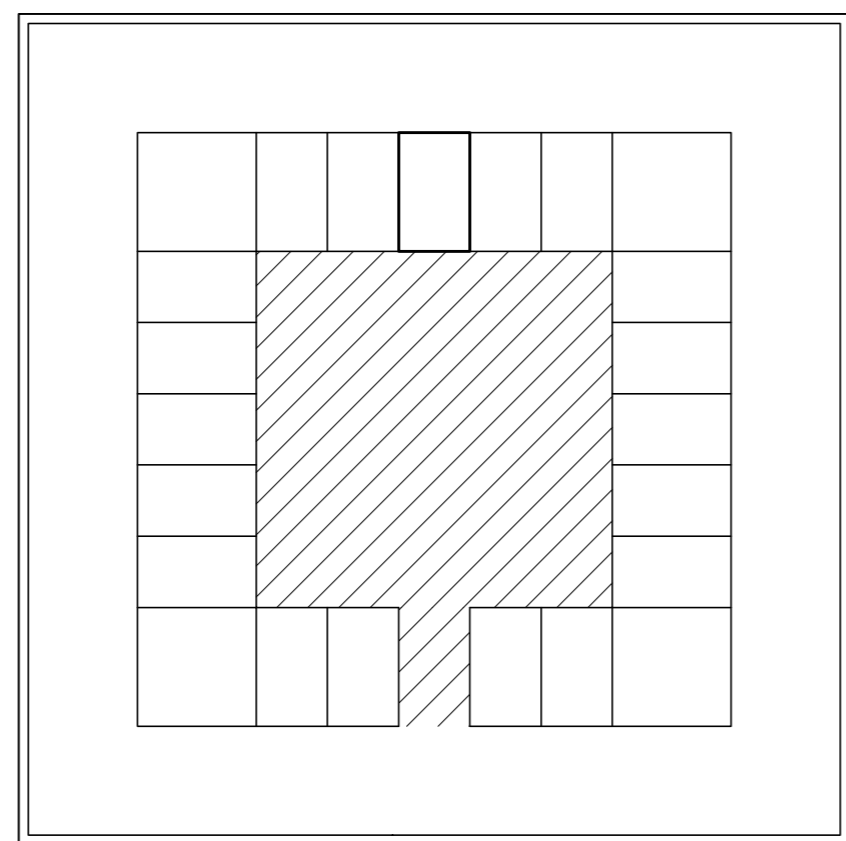
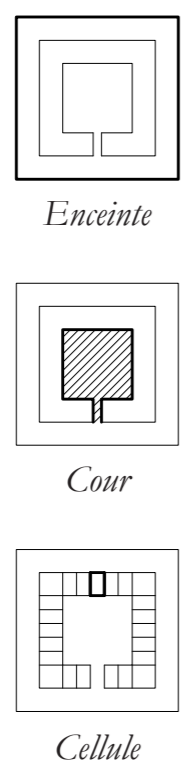

Enclave
Système composé d'un ensemble clos par une enceinte, organisé autour d'une ou plusieurs cours, et divisé en un grand nombre de cellules identiques. Le tout forme un lieu autonome, isolé de l'environnement urbain.

FAIBLESSES

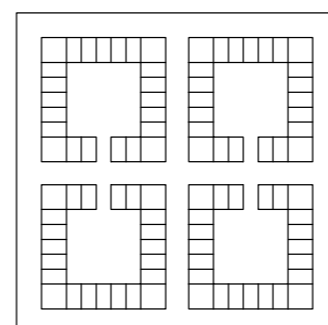

Redondance
Répétitions & homogénéité spatiale

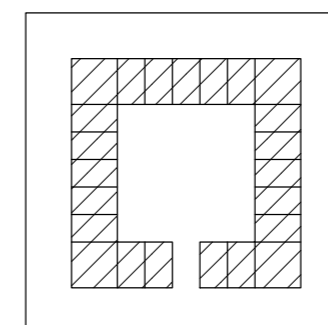

Déterminisme
Hyperspécialisation & espaces complexes

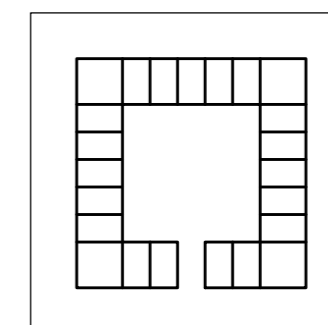

Rigidité
Structures spatiales lourdes

OCCUPATION TEMPORAIRE Quels sont ses bienfaits ?

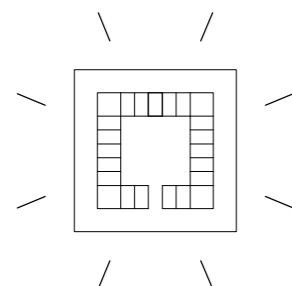

Occupation temporaire
C'est l'aménagement d'un espace pour une appropriation à court terme, afin de le valoriser et y générer des interventions architecturales à long terme.

VALORISATION

Physique / Désenclavement physique, Symbolique / Storytelling, Patrimoniale / Patrimonialisation, Matérielle / Non obsolescence, Sociale / Désenclavement social

ARCHITECTURE FLEXIBLE Quelles sont ses caractéristiques ?

STRUCTURE PRIMAIRE PÉRENNE

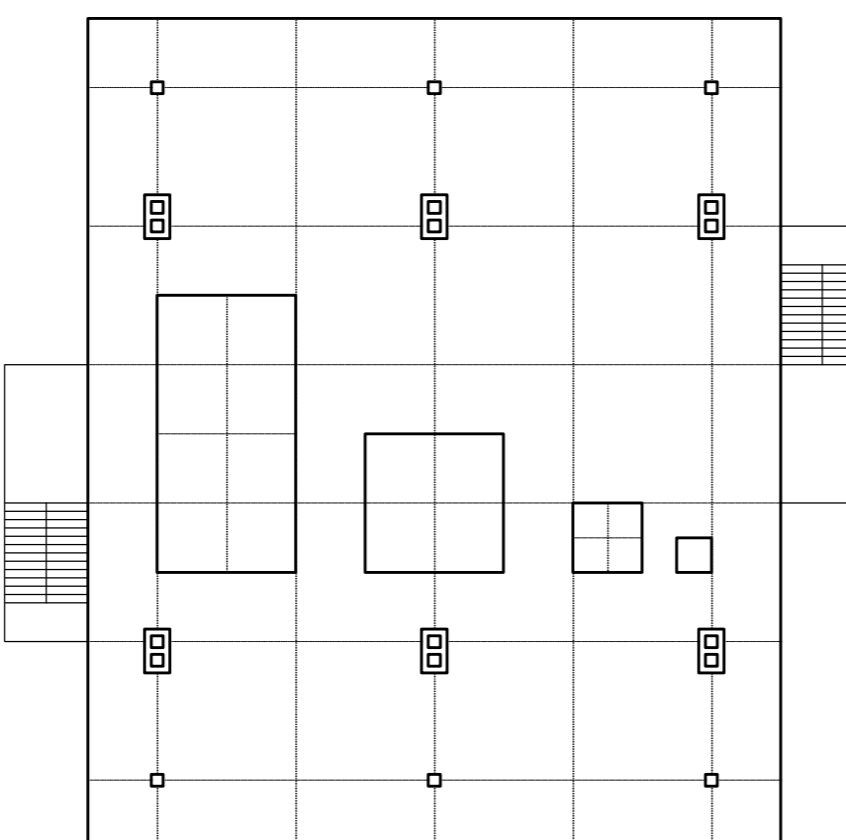
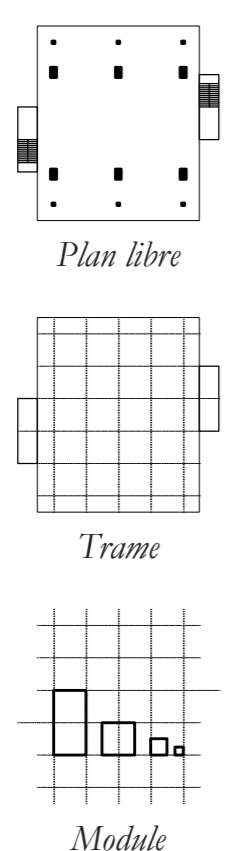

Flexibilité
La flexibilité d'une architecture est sa capacité à articuler : des espaces permanents, garantissant sa pérennité ; et des espaces temporaires, permettant une variabilité d'usages au cours du temps.

STRUCTURE SECONDAIRE VARIABLE

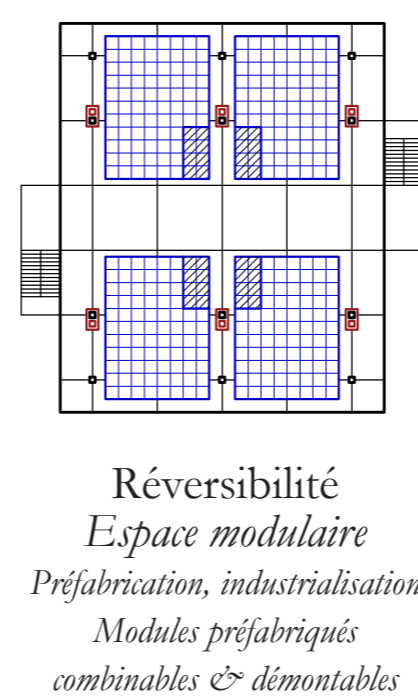

Réversibilité
Espace modulaire
Préfabrication, industrialisation
Modules préfabriqués combinables & démontables

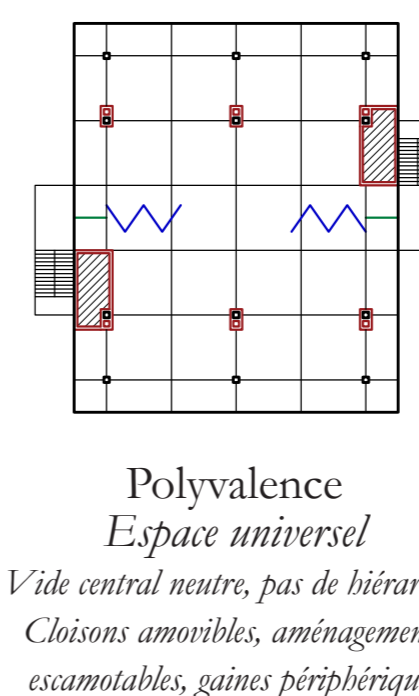

Polyvalence
Espace universel
Vide central neutre, pas de hiérarchie
Cloisons amovibles, aménagements escamotables, gaines périphériques

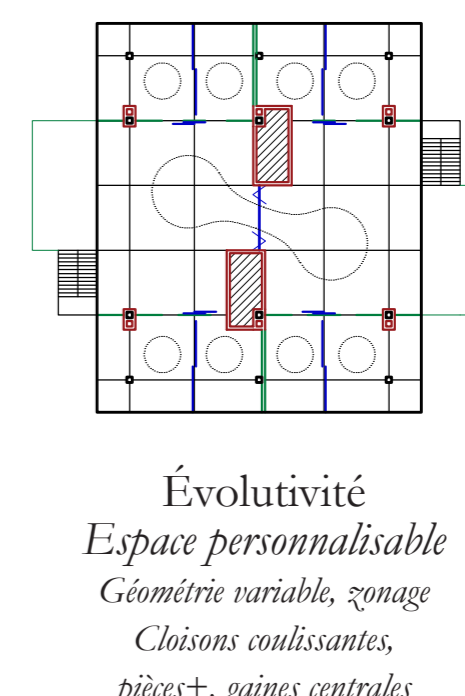

Évolutivité
Espace personnalisable
Géométrie variable, zonage
Cloisons coulissantes, pièces+, gaines centrales

PATRIMOINE FLEXIBLE Quelles interventions ?

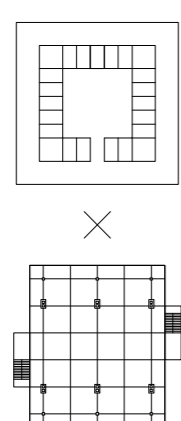

Patrimoine flexible
La flexibilité du patrimoine, qu'il soit reconnu ou en devenir, c'est sa capacité à transmettre une structure pérenne, support d'aménagements flexibles au gré des usages.

POTENTIELS & FREINS À LA FLEXIBILITÉ DU PATRIMOINE ENCLAVÉ

+ Trame // Quadrillage
Logique des interventions vis-à-vis de l'existant

+ Module // Cellule
Systématiser les interventions

- Plan libre // ?
Assouplissements du plan pour le libérer de ses contraintes

CARACTÉRISTIQUES TYPOLOGIQUES

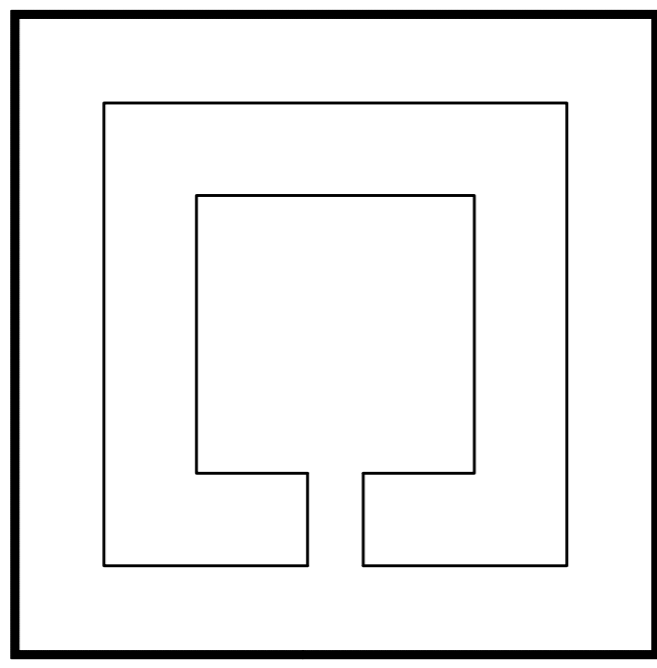

Encinte

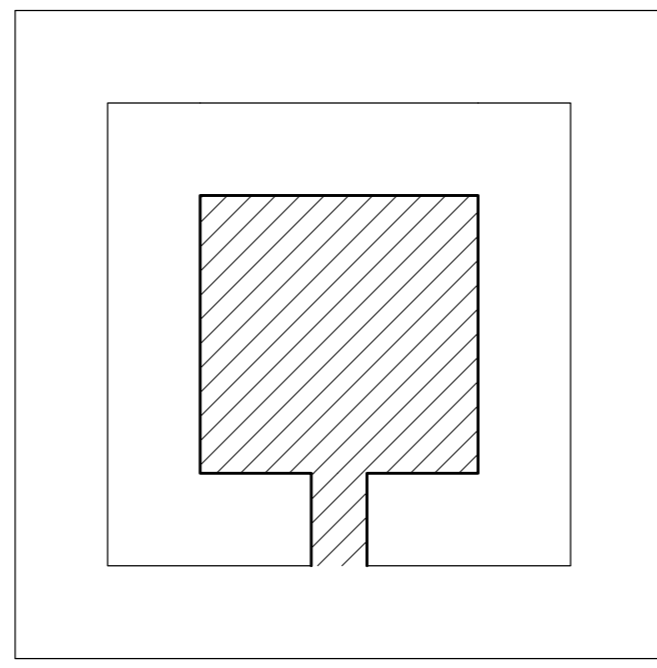

Cour

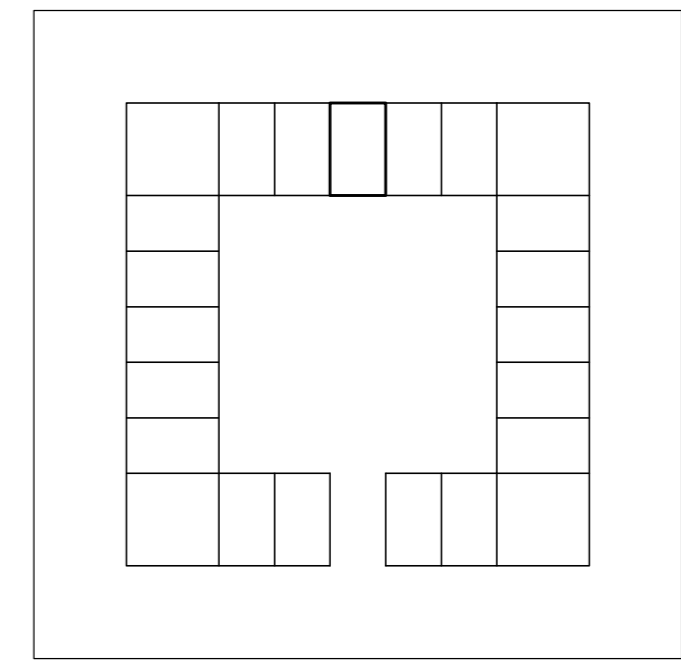

Cellule

DÉSENCLAVER L'ENCEINTE

POTENTIALISER LA COUR

HABITER LES CELLULES

INTERVENTIONS LÉGÈRES

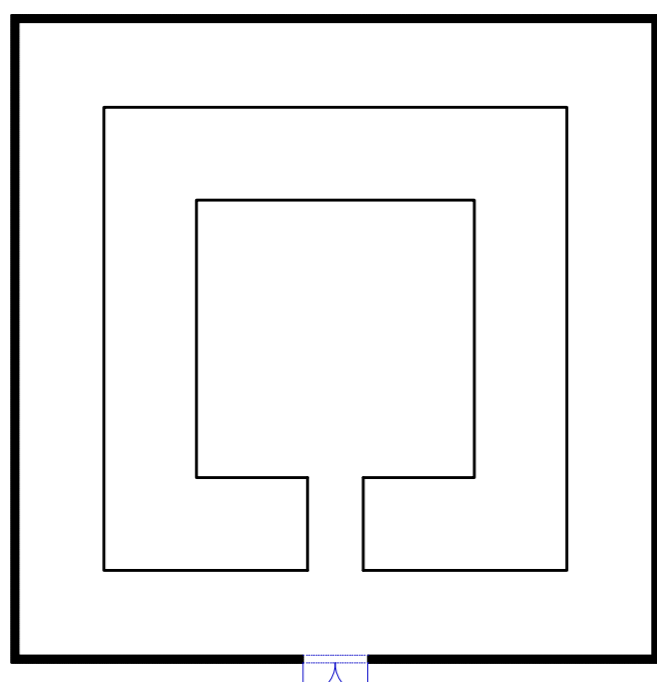

Ouvrir les portes
Caserna Pepe
Casernes d'Ixelles
Hospice St-V-de-P
Prison d'Haasselt

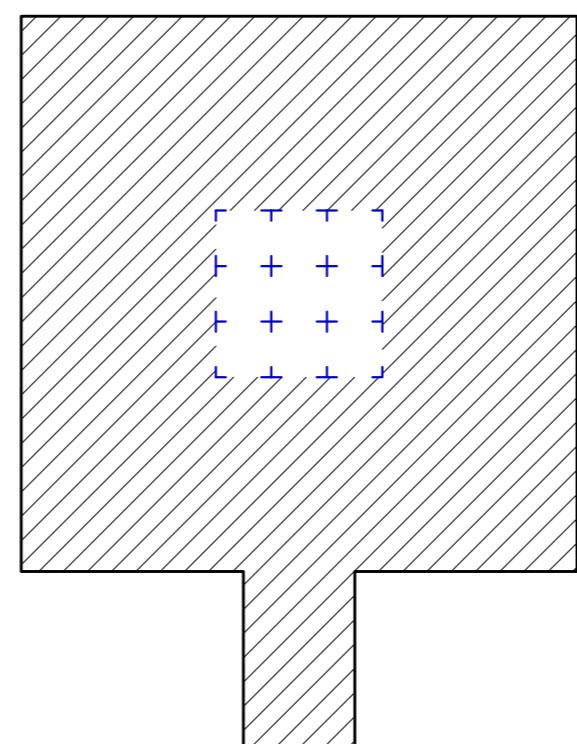

Activer la centralité
Caserna Pepe
Casernes d'Ixelles
Hospice St-V-de-P

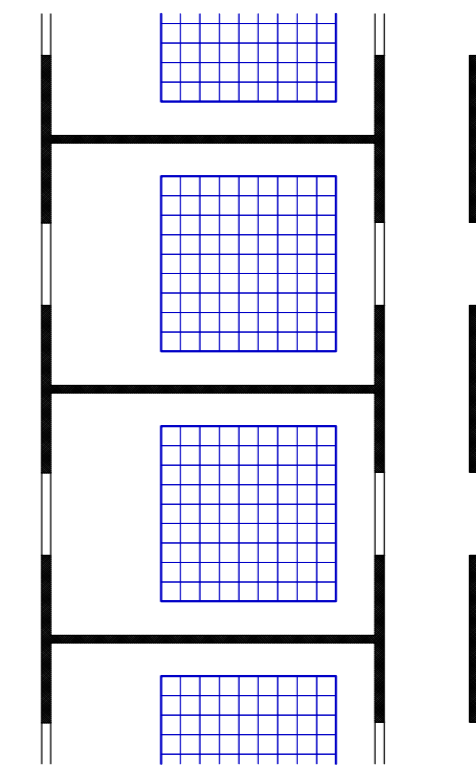

Multiplier les modules
Caserna Pepe

INTERVENTIONS PONCTUELLES

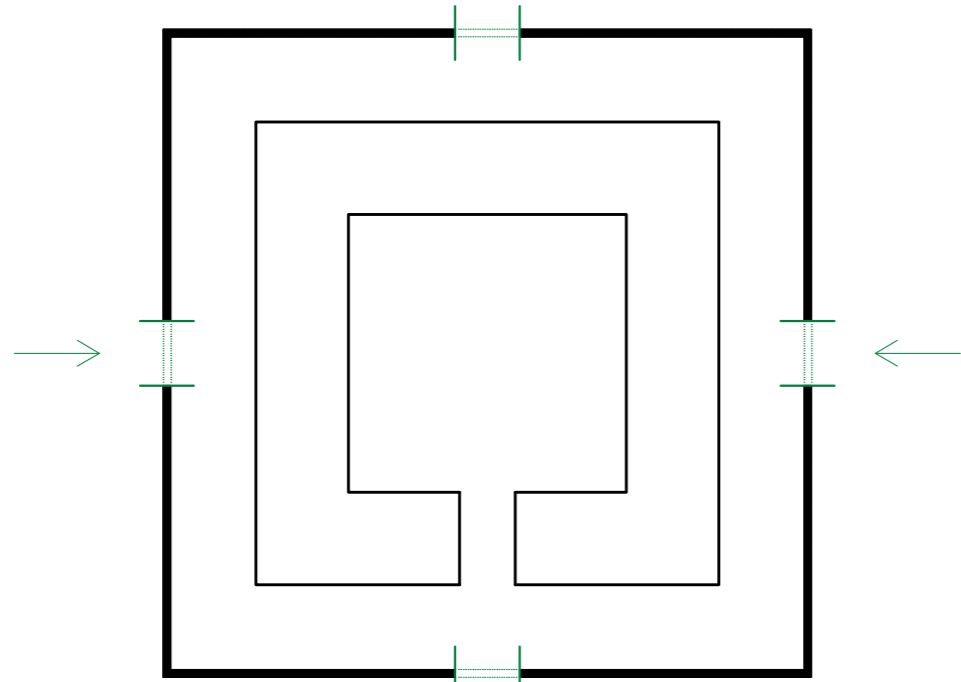

Percer l'enceinte
Casernes d'Ixelles
Hospice St-V-de-P
Prison d'Haasselt

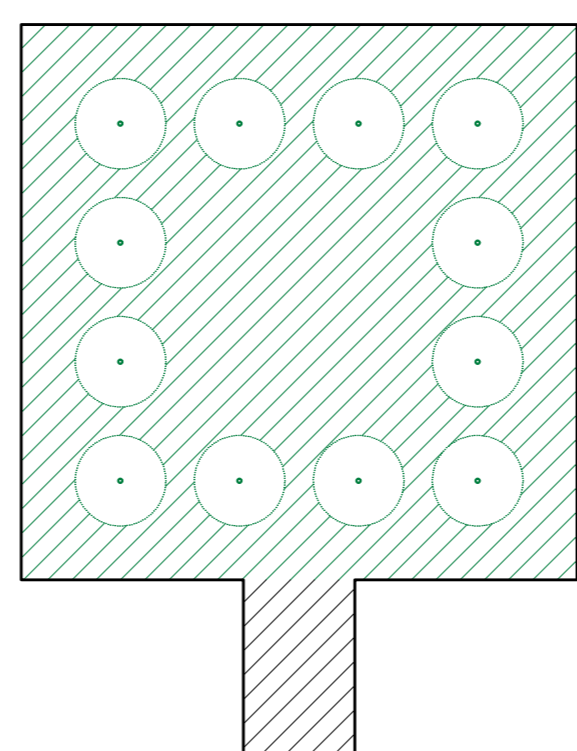

Habiller la cour
Casernes d'Ixelles
Hospice St-V-de-P
Prison d'Haasselt

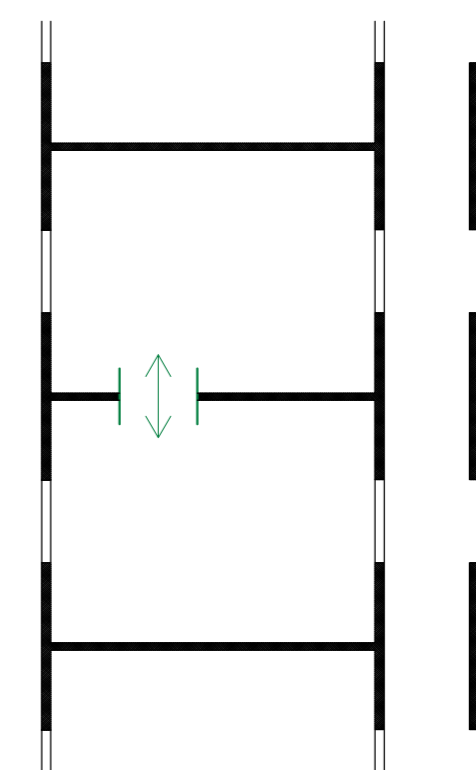

Connecter les cellules
Casernes d'Ixelles
Hospice St-V-de-P
Prison d'Haasselt

INTERVENTIONS LOURDES

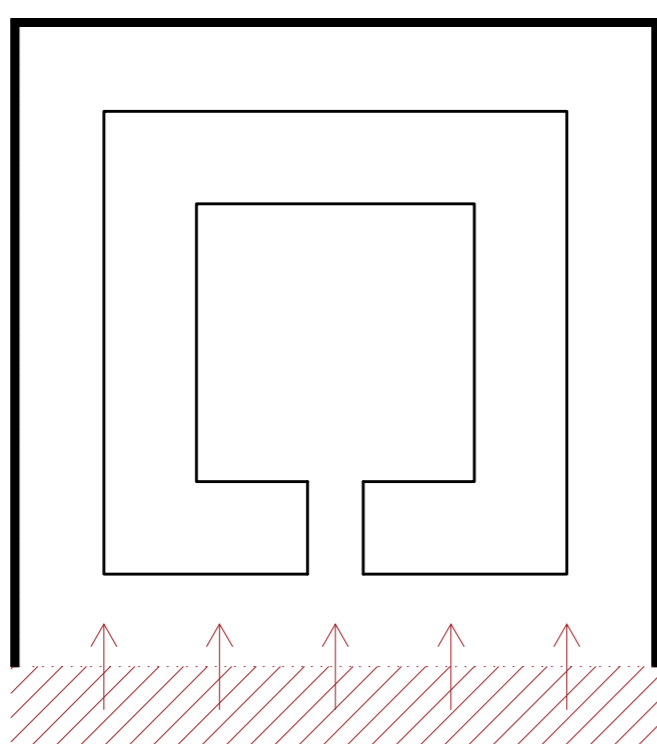

Ouvrir l'enceinte
Casernes d'Ixelles
Hospice St-V-de-P
Prison d'Haasselt

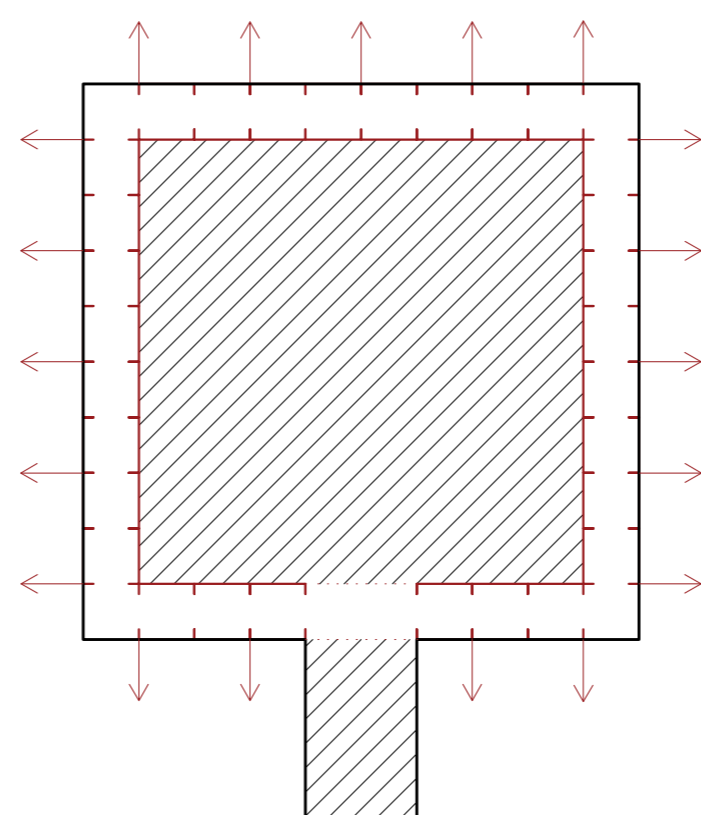

Border la cour
Hospice St-V-de-P
Prison d'Haasselt

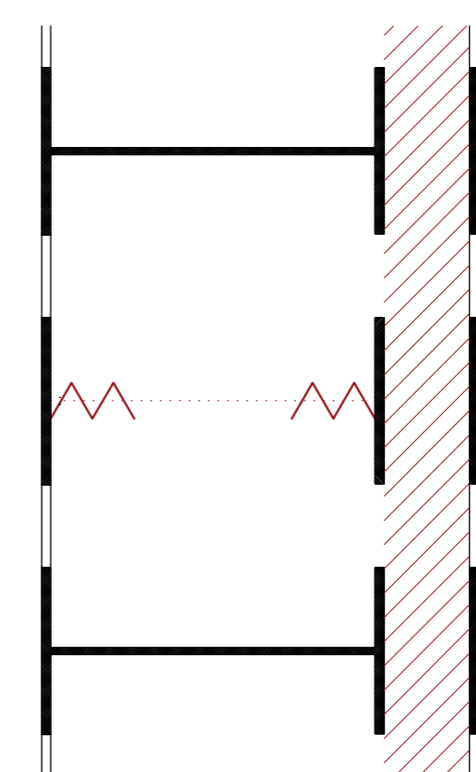

Fusionner les cellules
Prison d'Haasselt

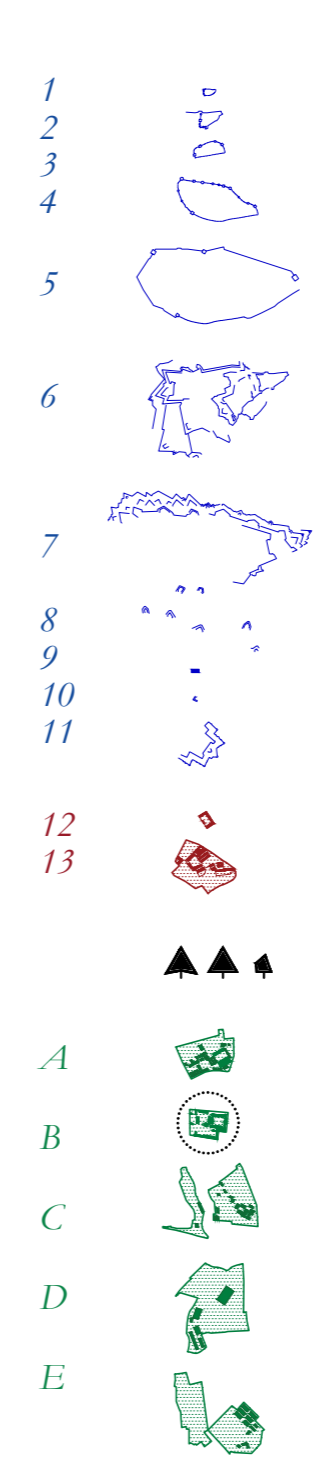
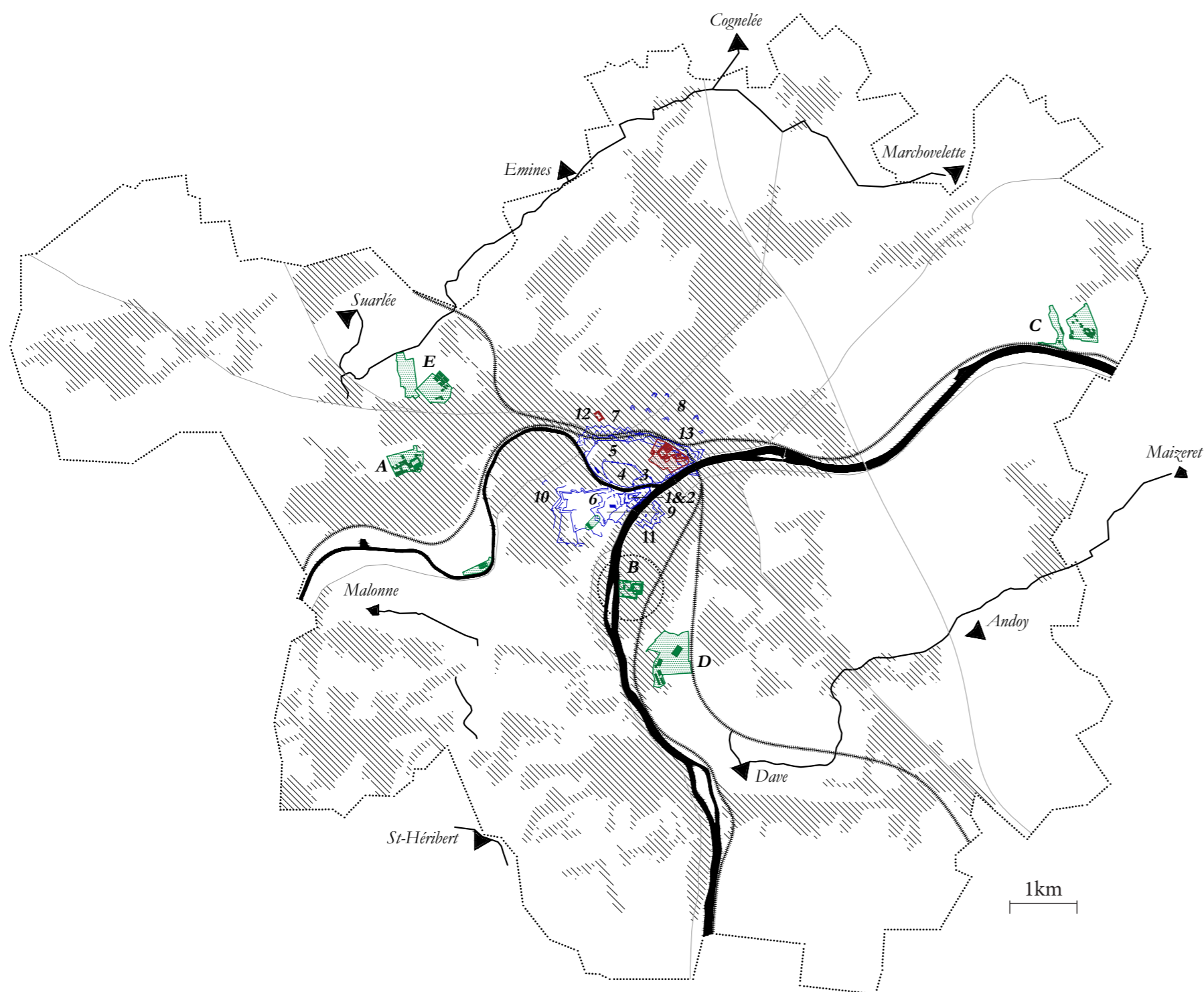

- FORTERESSE III-XVIII
1. Mur Bas-Empire III-IV
 - Château des Comtes XII-XV
 - Rempart contrescarpe XIV
 2. Grognon & Enceinte 1 X-XI
 - Rempart XII-XVI-XVII
 3. Enceinte 2 XII
 4. Enceinte 3 XIII
 5. Enceinte 4 XIV-XV
 6. Médiante XVI
 7. Enceinte urbaine XVII-XVIII
 8. Forts XVII
 9. Terra Nova XVII
 10. Fort d'Orange XVII
 11. Fortification Jambes XVII-XVIII
- GARNISON XIX
12. Caserne Marie-Henriette XIX
 13. Casernes des Lanciers Léopold 1885
- CEINTURE FORTS 1888
- DISPERSION FIN XX
- A. Caserne Sous-Lieutenant Tribaut Flavinne 1937
 - B. Caserne Dewispelaere 1939
 - C. Commando Marche-les-Dames 1947
 - D. Site Sart-Hinlet
 - E. Quartier Plaine de Belgrade
- DEJARDIN, V., MAQUET, J. (2007)
Le patrimoine militaire de Wallonie
Institut du Patrimoine wallon

MORPHOGENÈSE

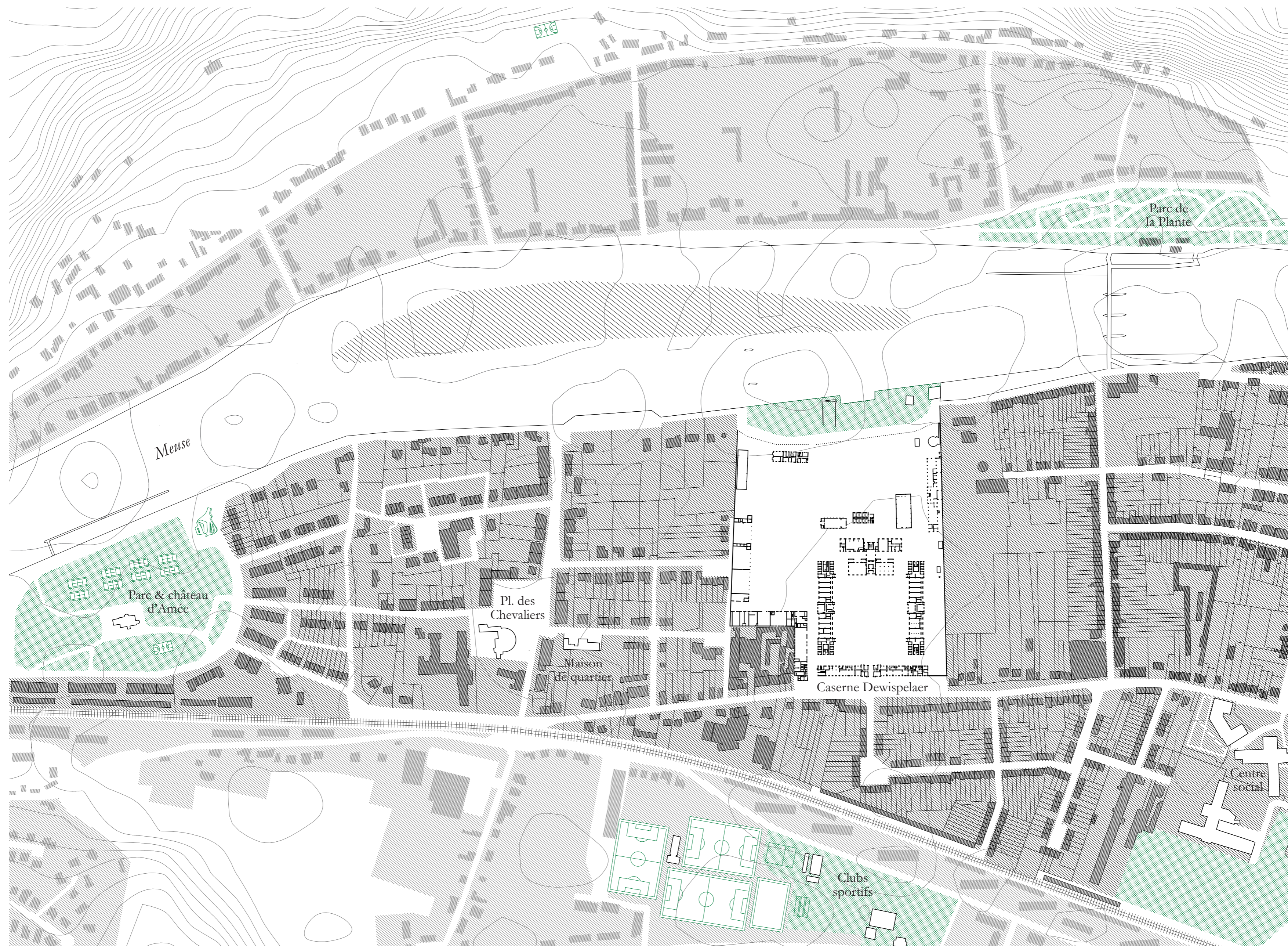
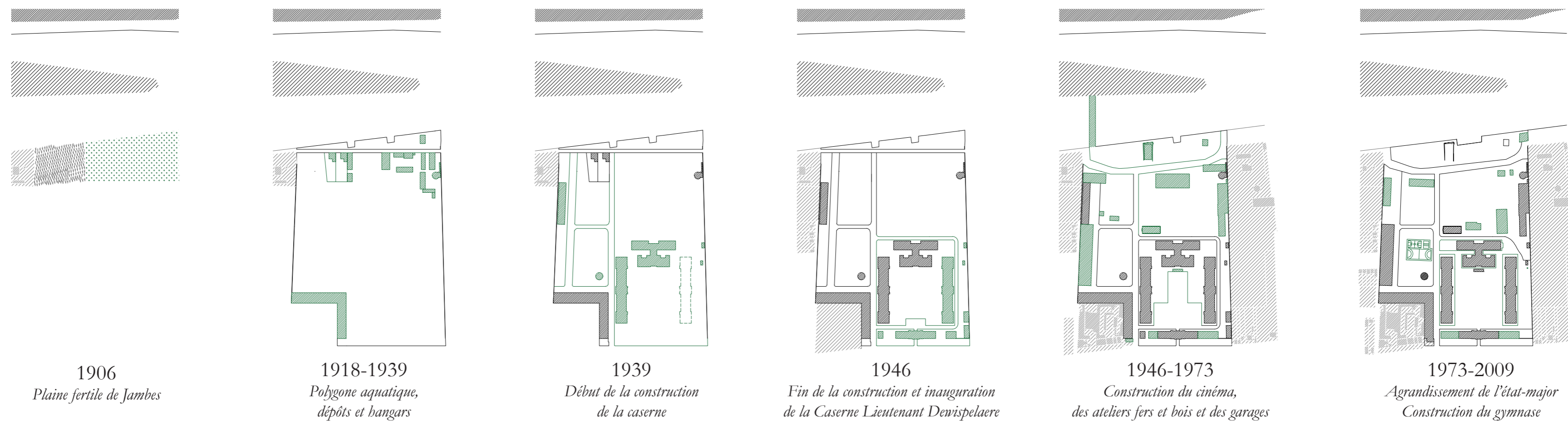

Situation existante



CARACTÉRISTIQUES TYPOLOGIQUES

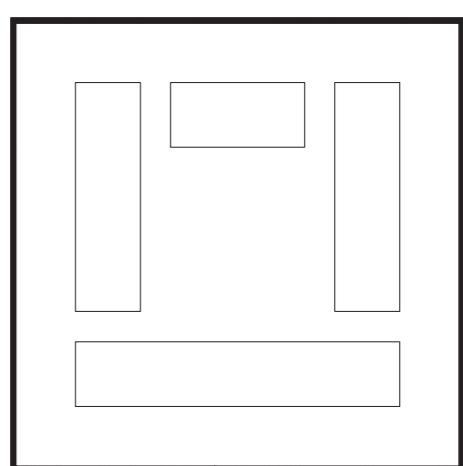

Encinte

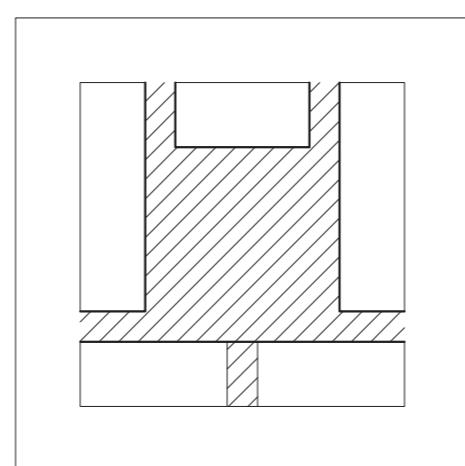

Cour

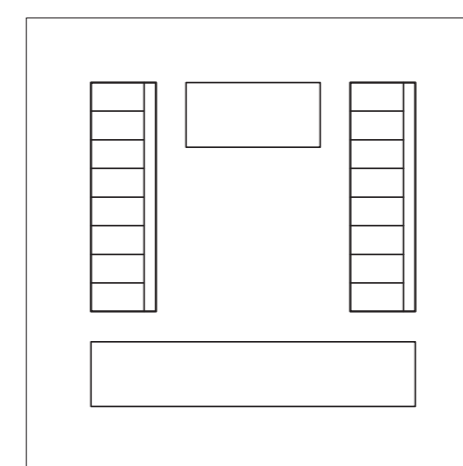

Cellules

SITUATION EXISTANTE

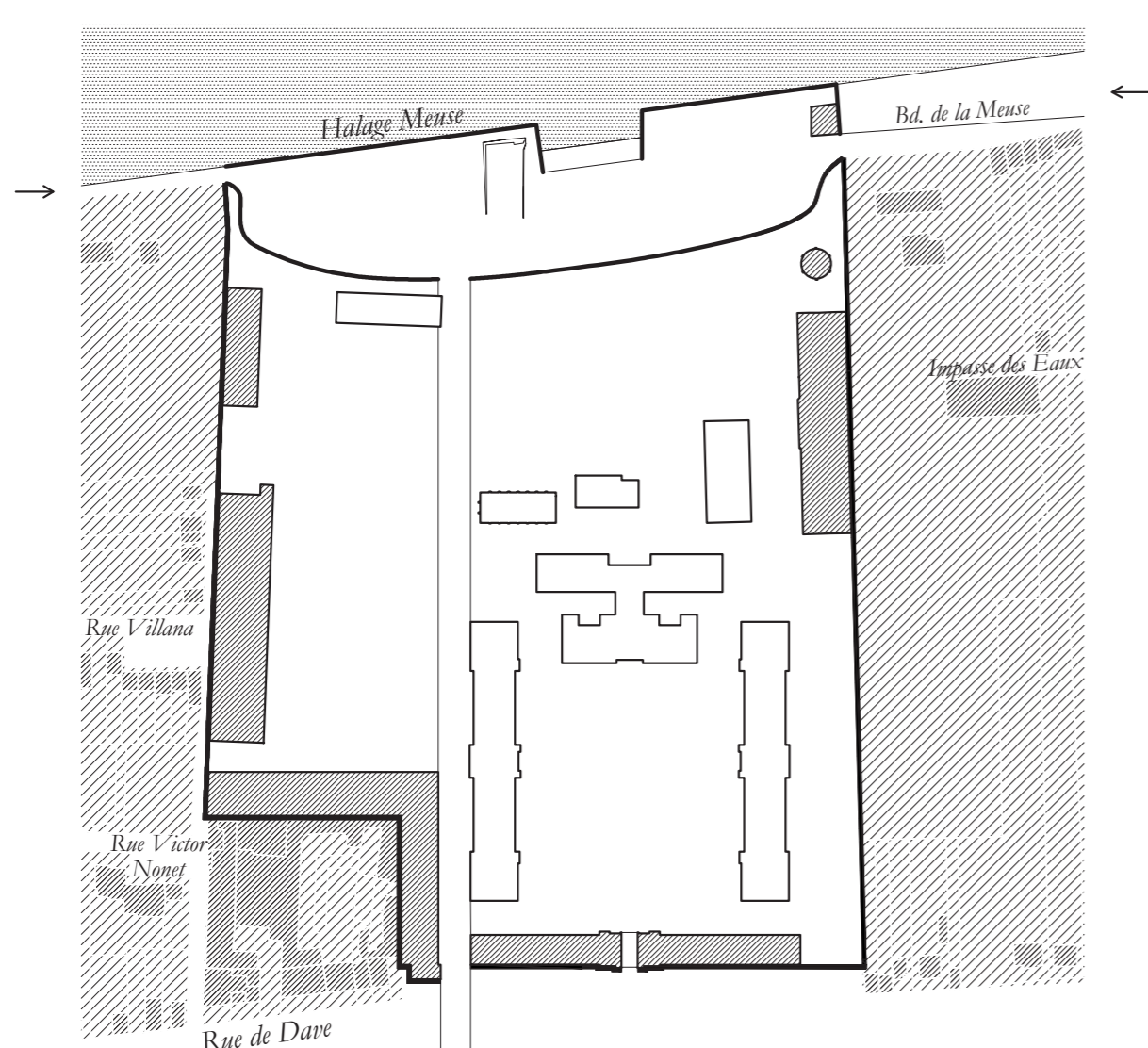

Encinte
Autonomie
Espace urbain clos

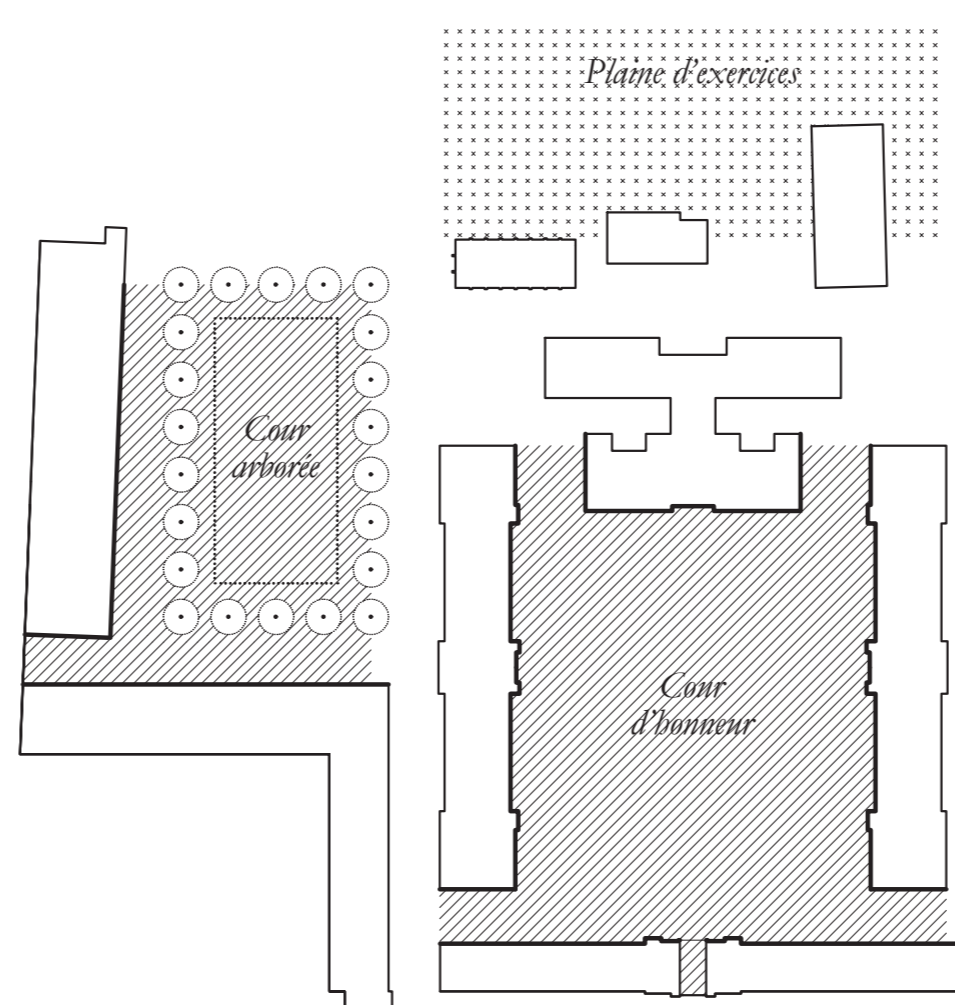

Cour
Centralisation
Composition spatiale centripète

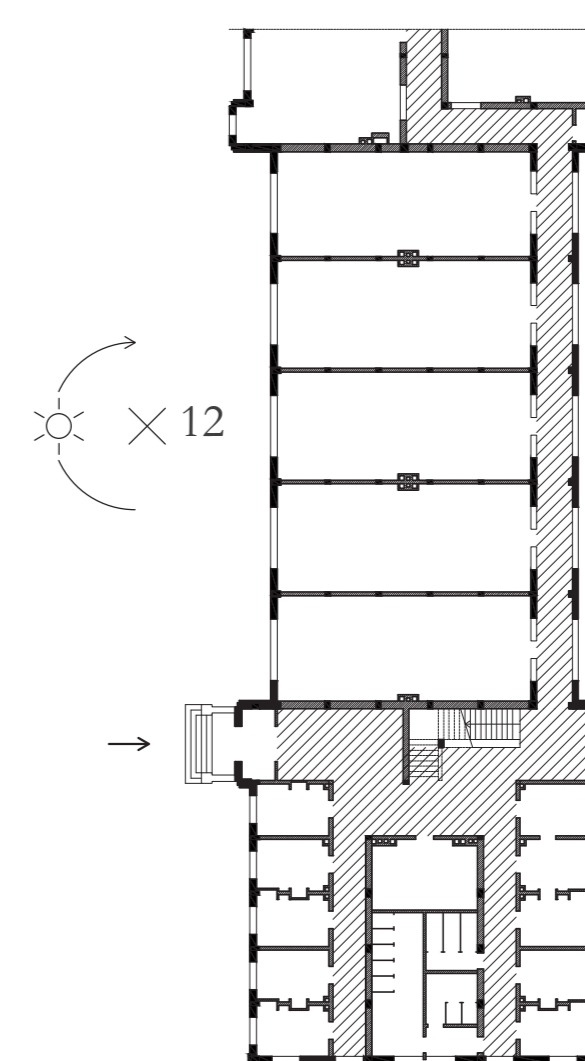

Cellules
Systématisation
Espaces rationnels et ordonnés

DÉSENCLAVER L'ENCEINTE

POTENTIALISER LA COUR

HABITER LES CELLULES

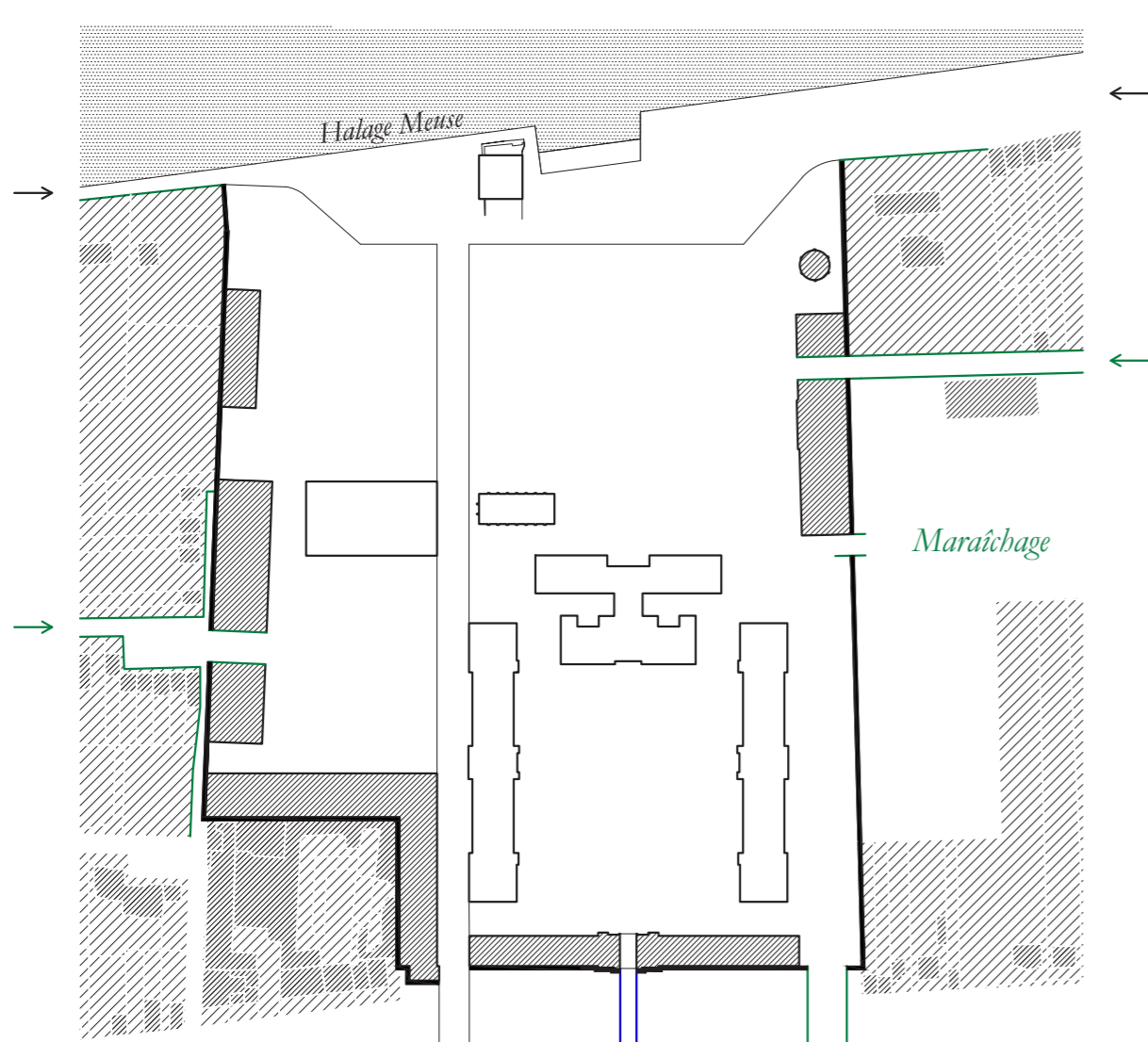

Encinte
Ouvrir les portes
Percer l'encinte
Connexions au quartier + Meuse

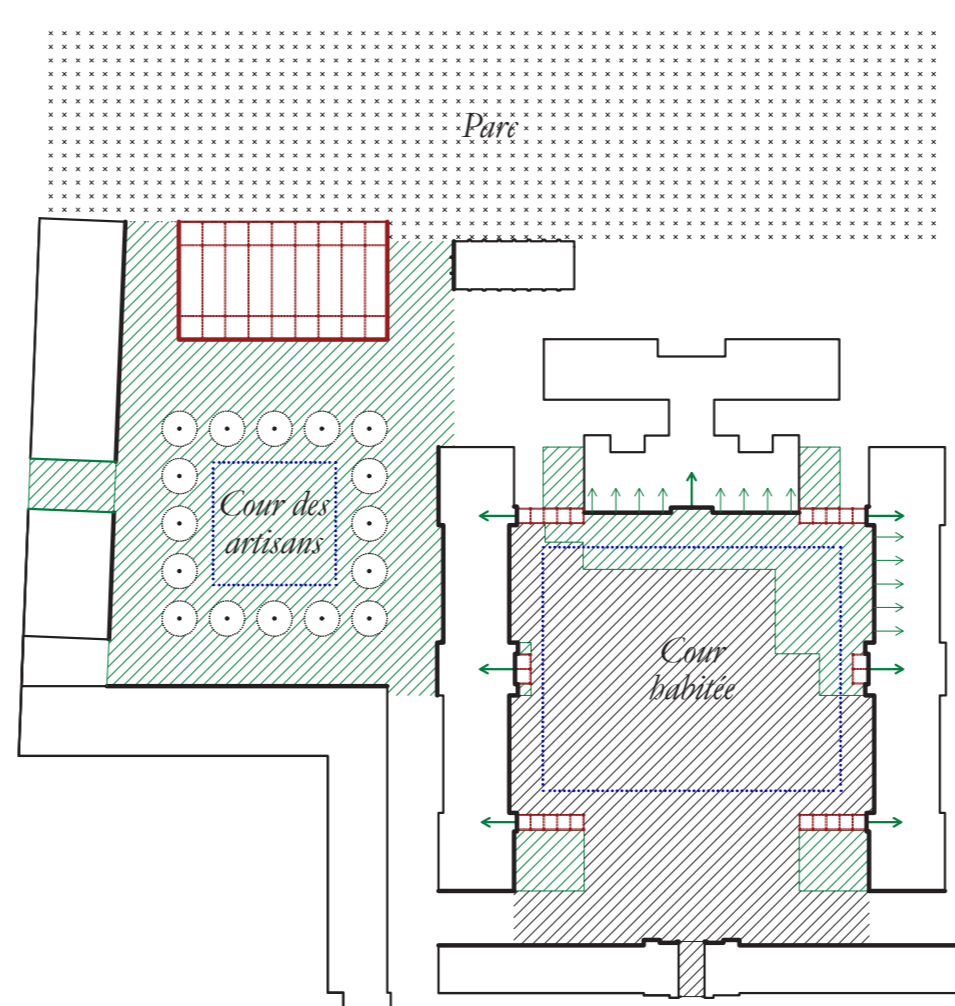

Cour
Activer la centralité
Habiller la cour
Border la cour
Cours redefinies + Parc

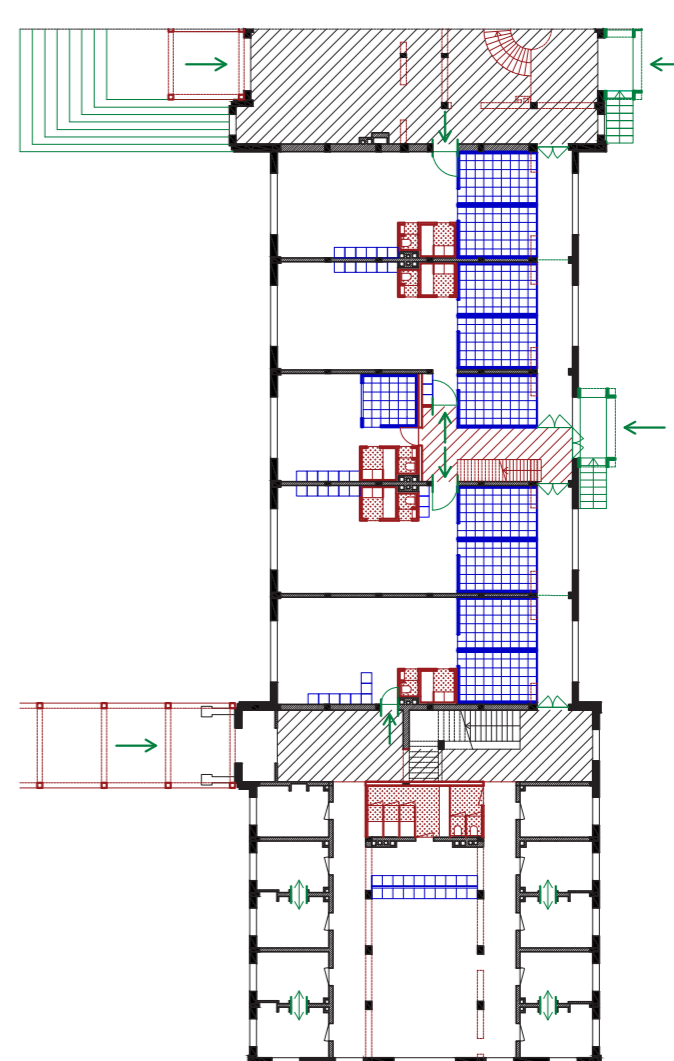

Cellule
Multiplier les modules
Connecter les cellules
Contour - Distribution verticale
Entrée au cœur du logement
Bloc technique
Modules réversibles

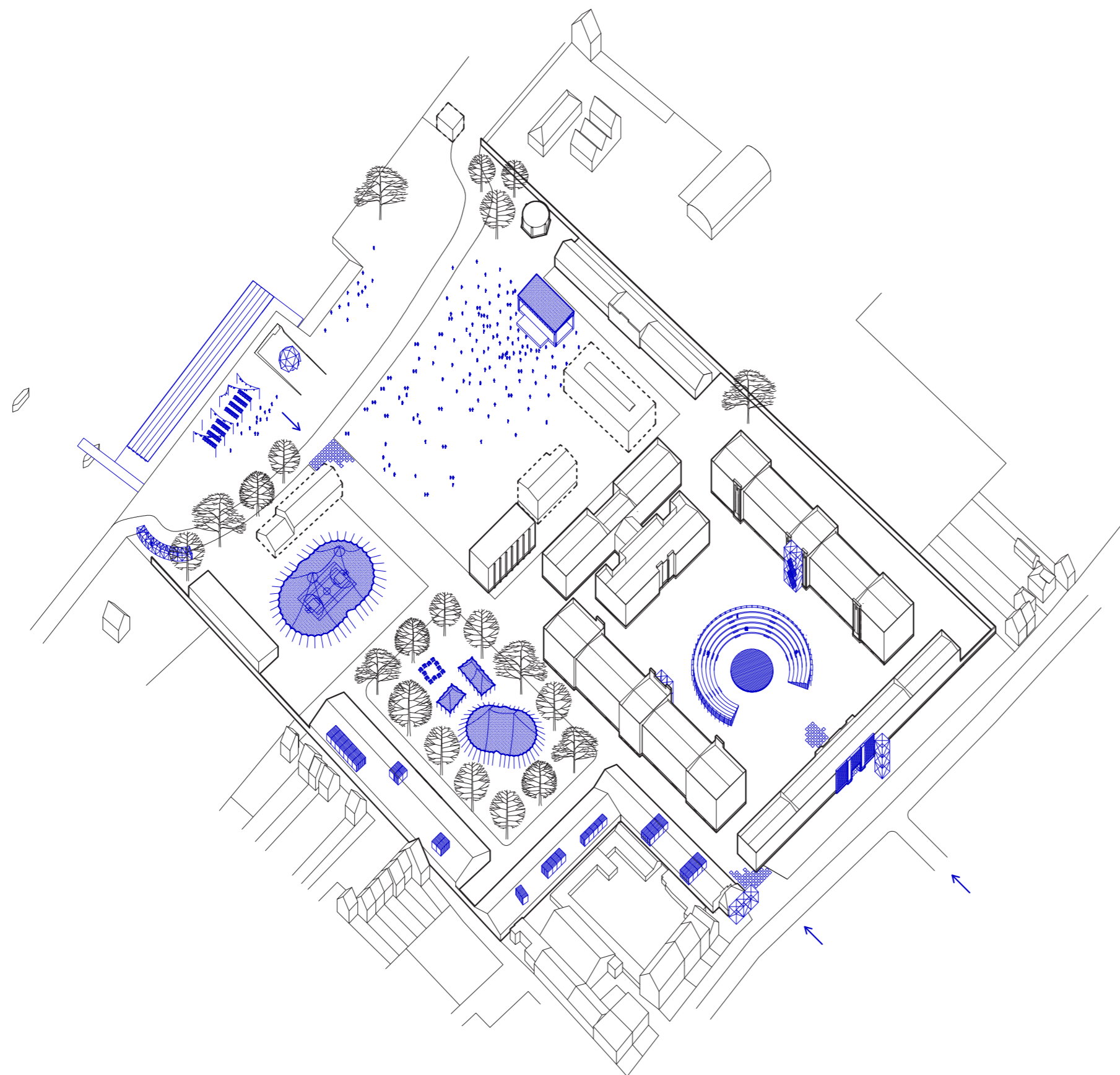

Interventions légères
Économie de moyens

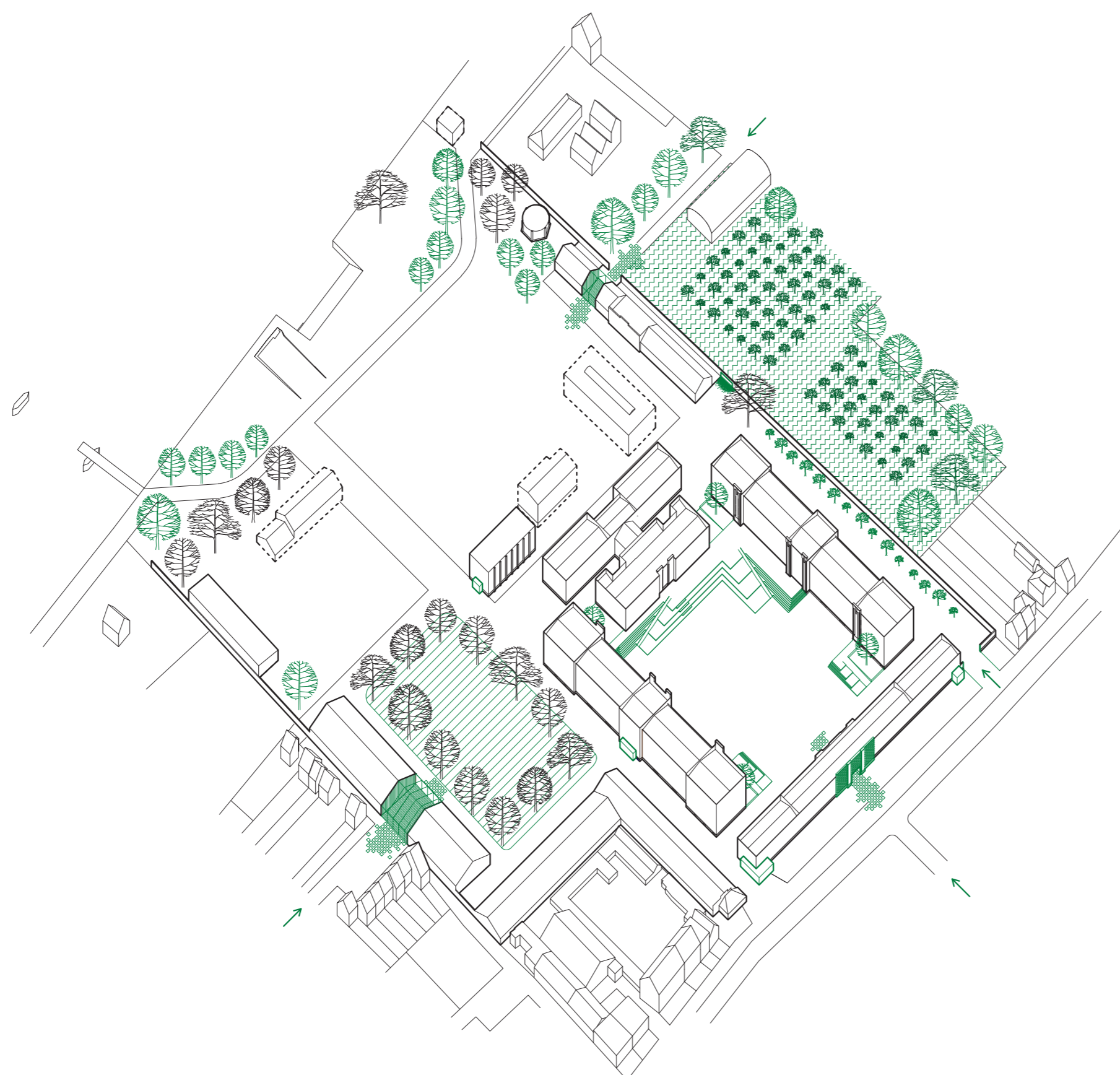

Interventions ponctuelles
Acupuncture spatiale

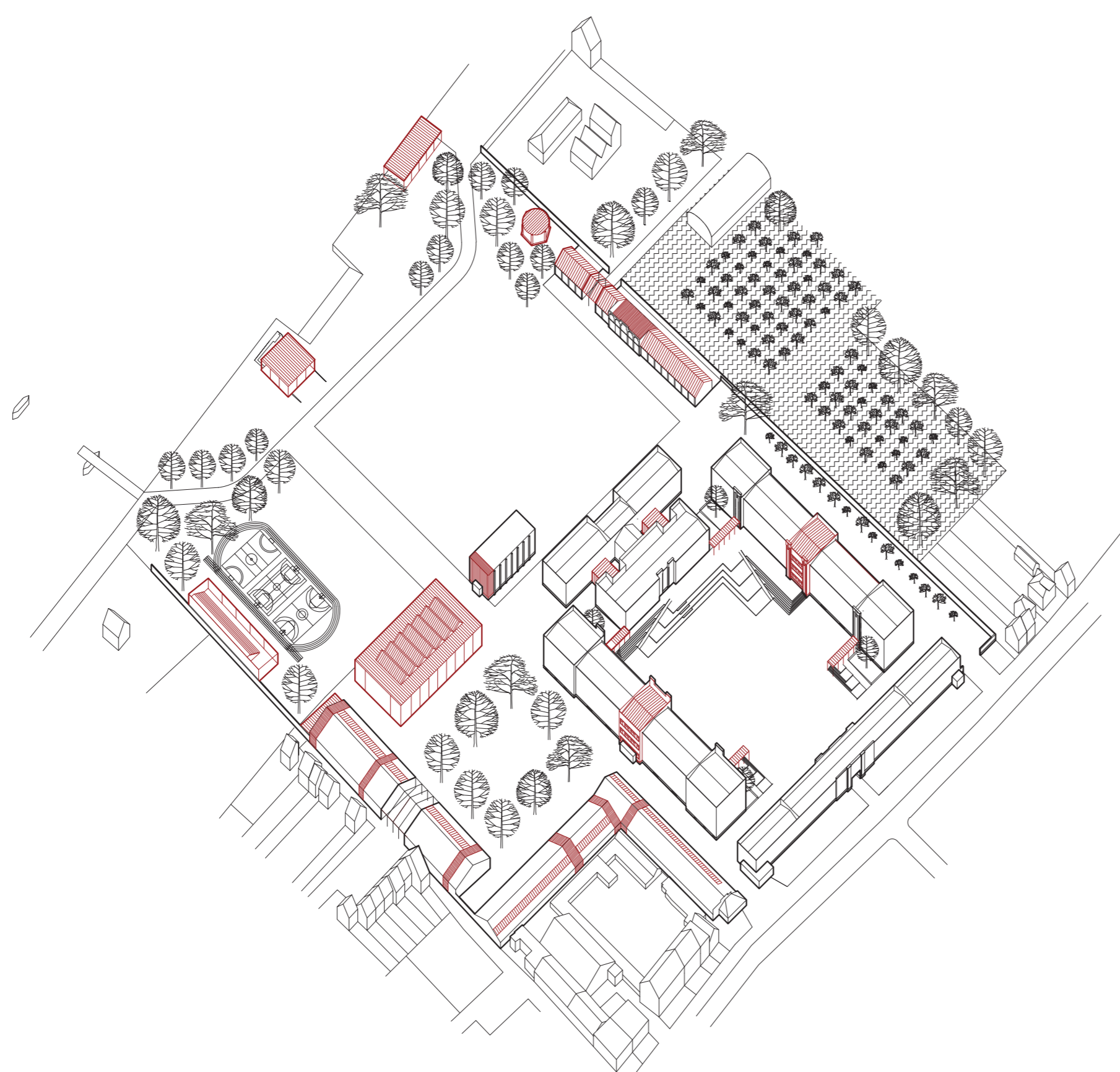

Interventions lourdes
Restructurations

INTERVENTIONS

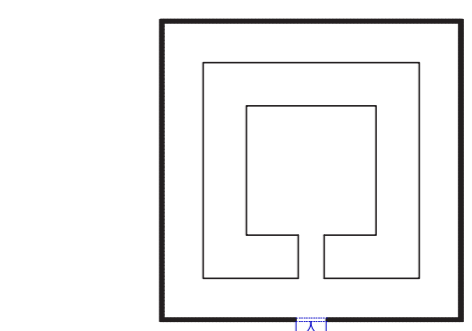

Ouvrir les portes

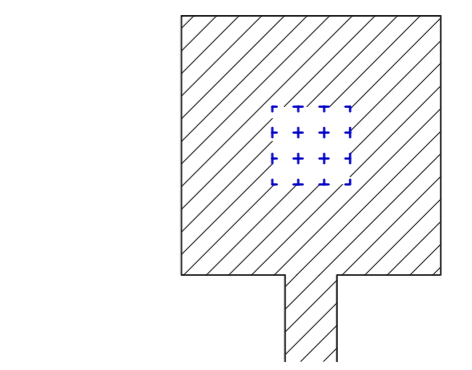

Activer la centralité

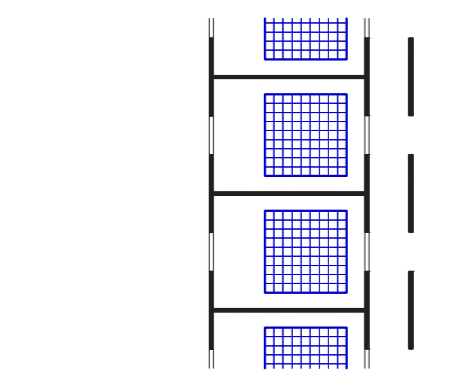

Multiplier les modules

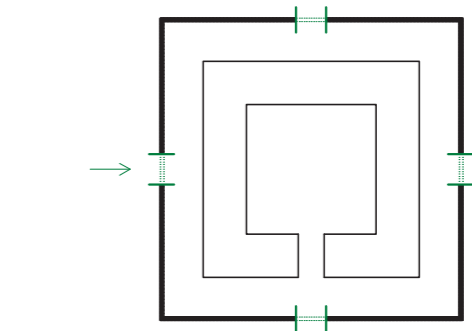

Percer l'enceinte

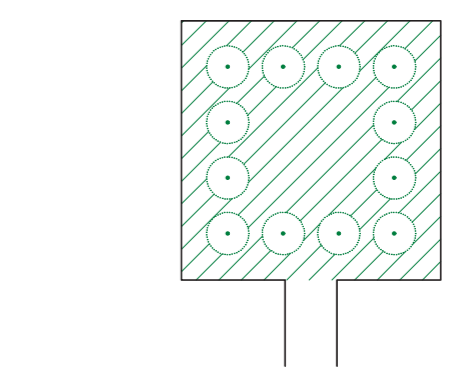

Habiller la cour

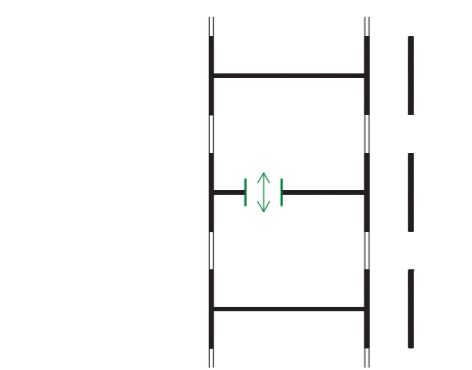

Connecter les cellules

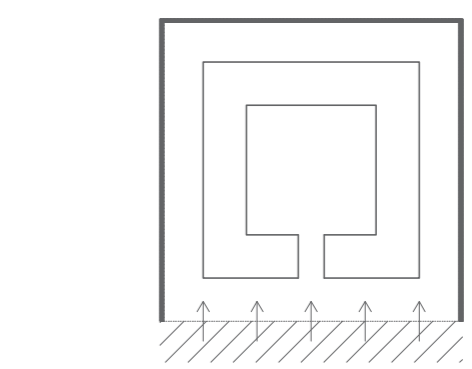

[Ouvrir l'enceinte]

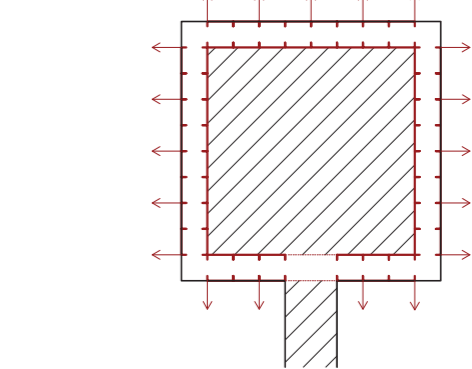

[Border la cour]

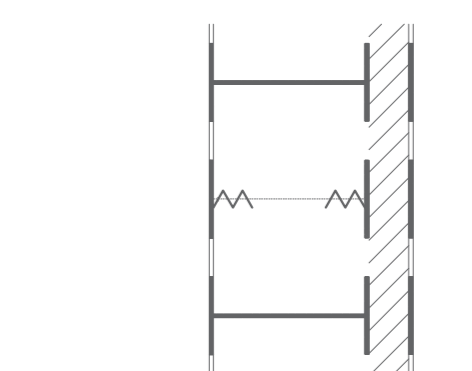

Fusionner les cellules

LÉGÈRES

PONCTUELLES

LOURDES

VISION

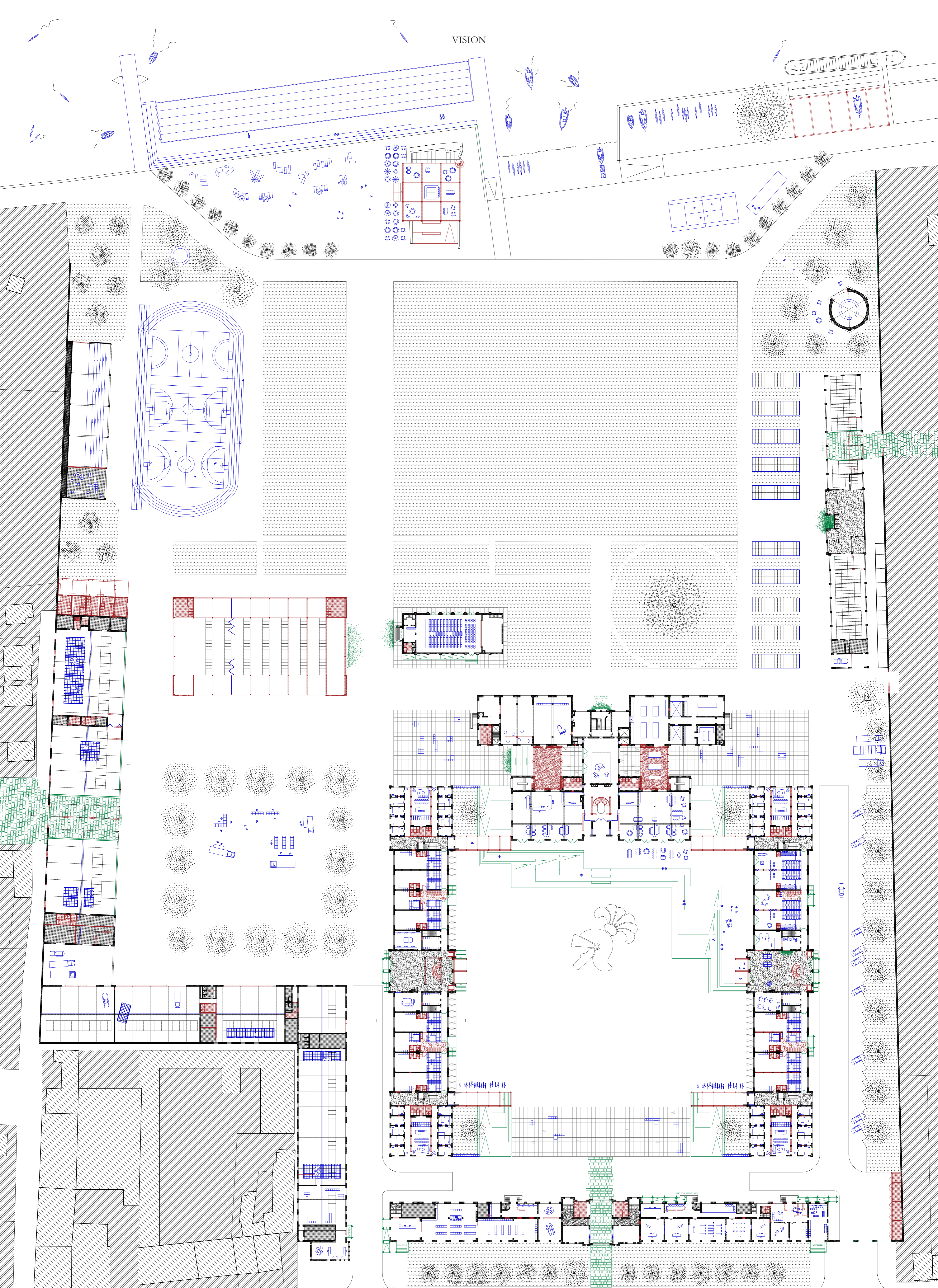

MATÉRIALITÉ

INVARIABLE

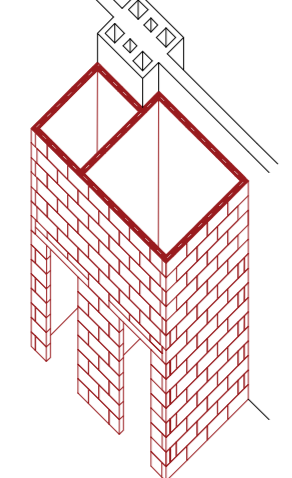

Bloc technique

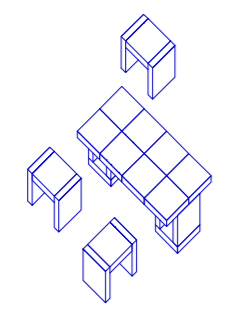

Mobilier

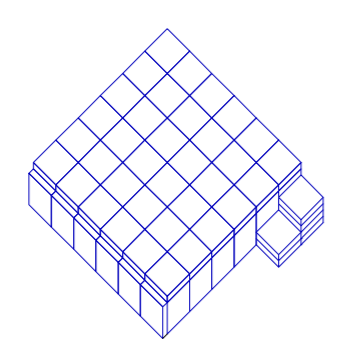

Estrade

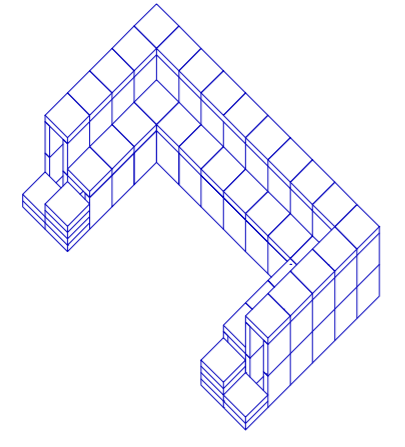

Gradin

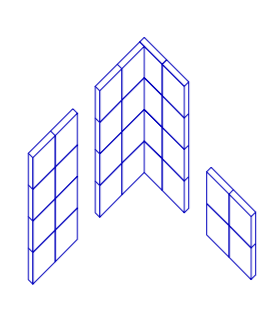

Installation

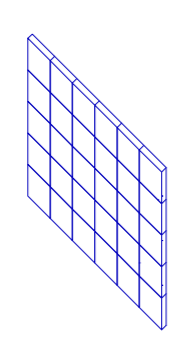

Cloisons

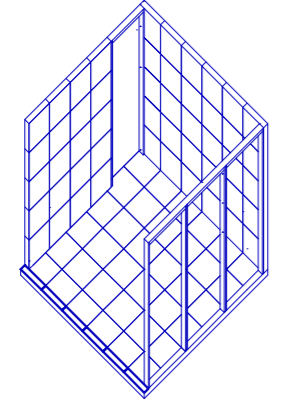

Module 3x3 m

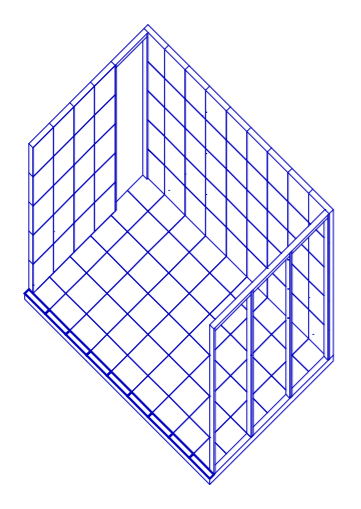

Module 3x4.5 m

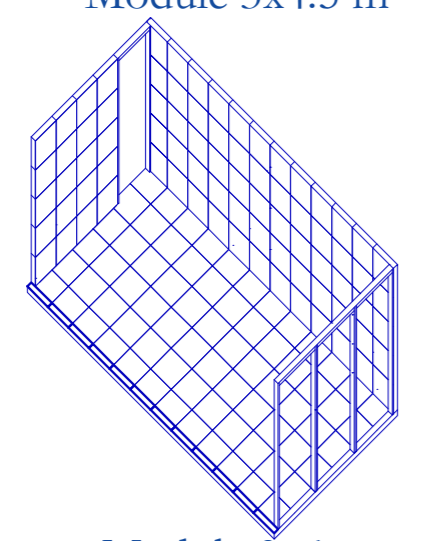

Module 3x6 m

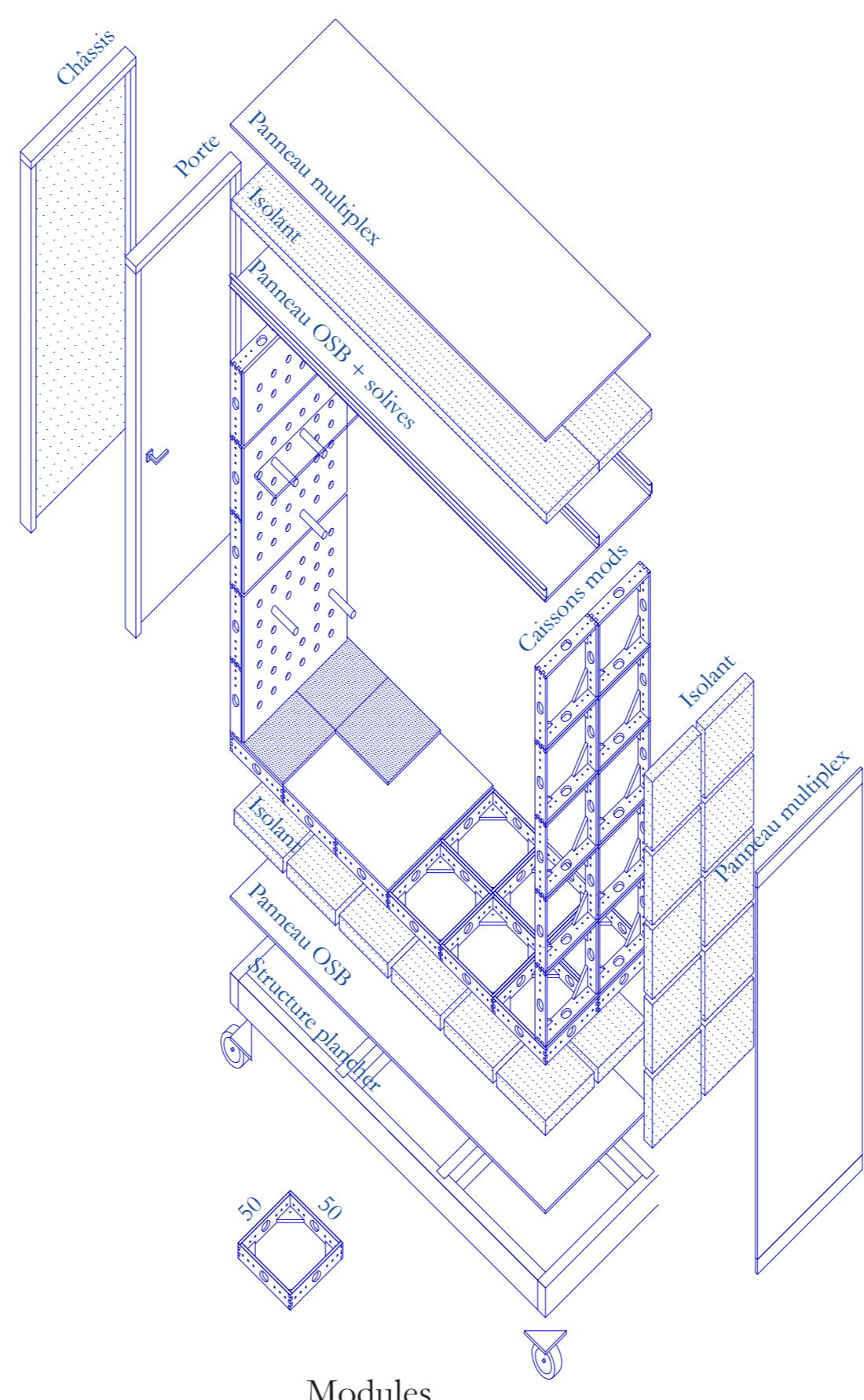

Modules
Espaces variables

VARIABLE

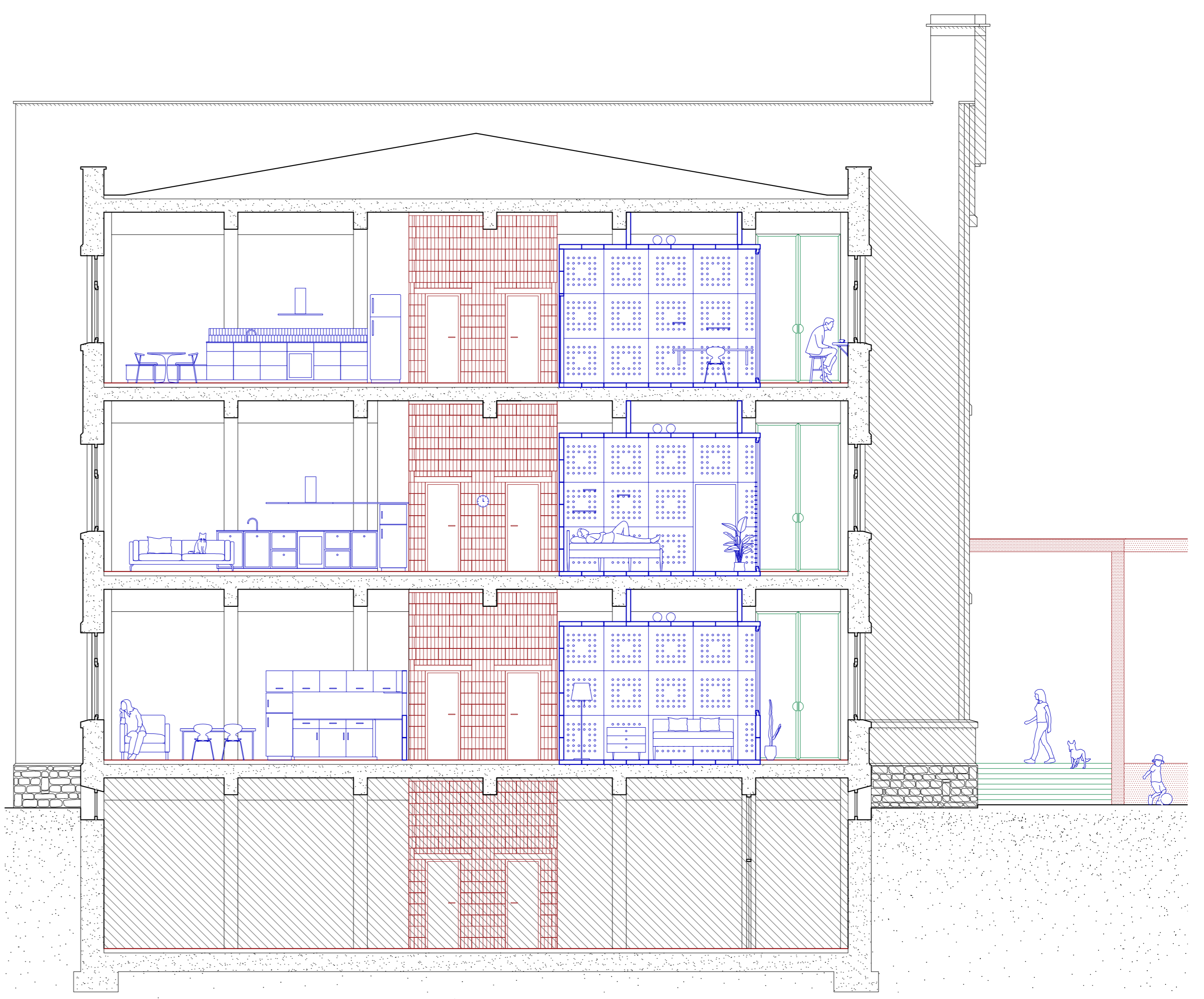

Habiter les cellules
Espaces flexibles

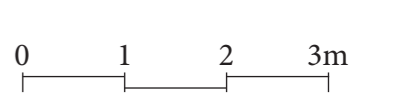

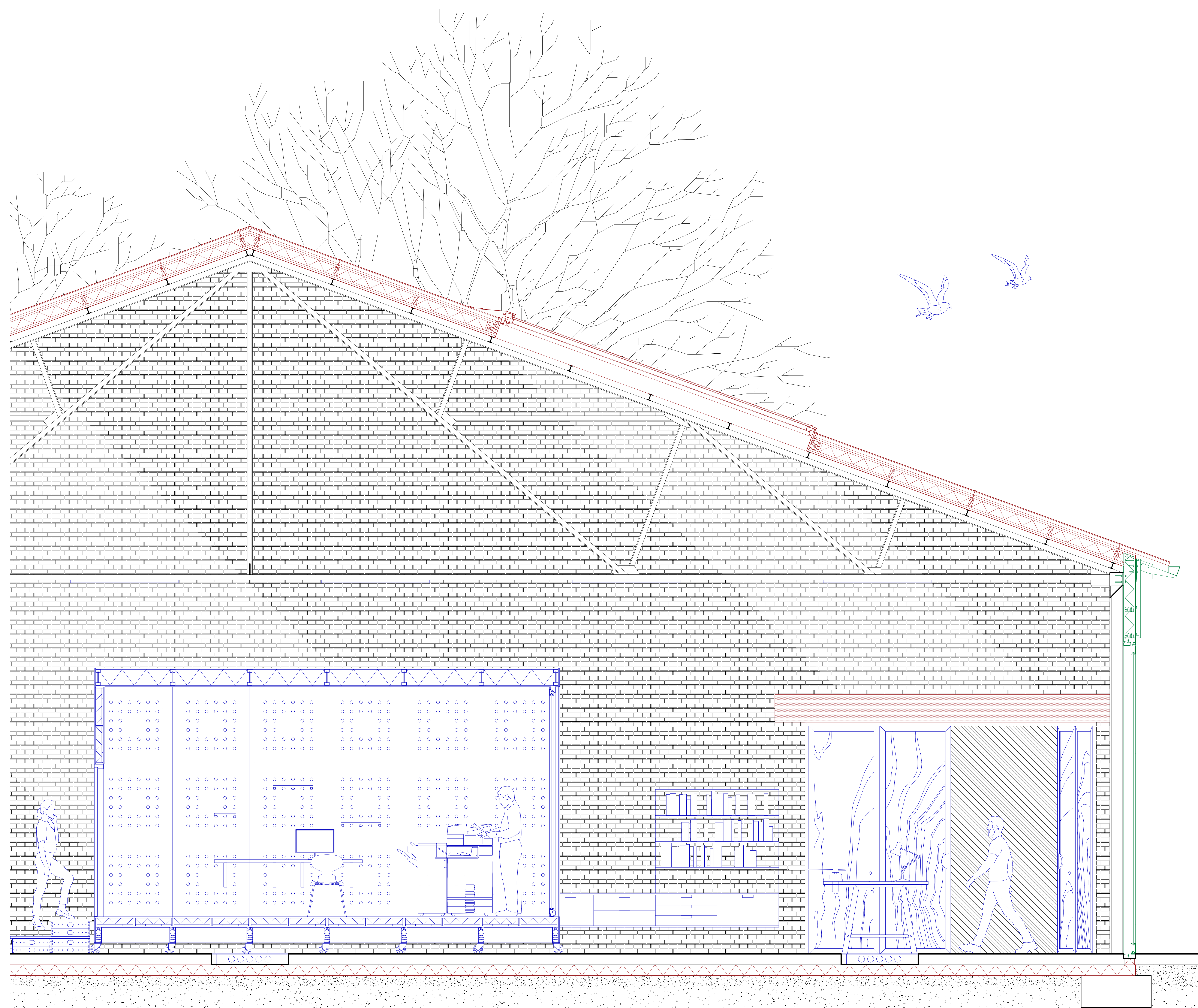
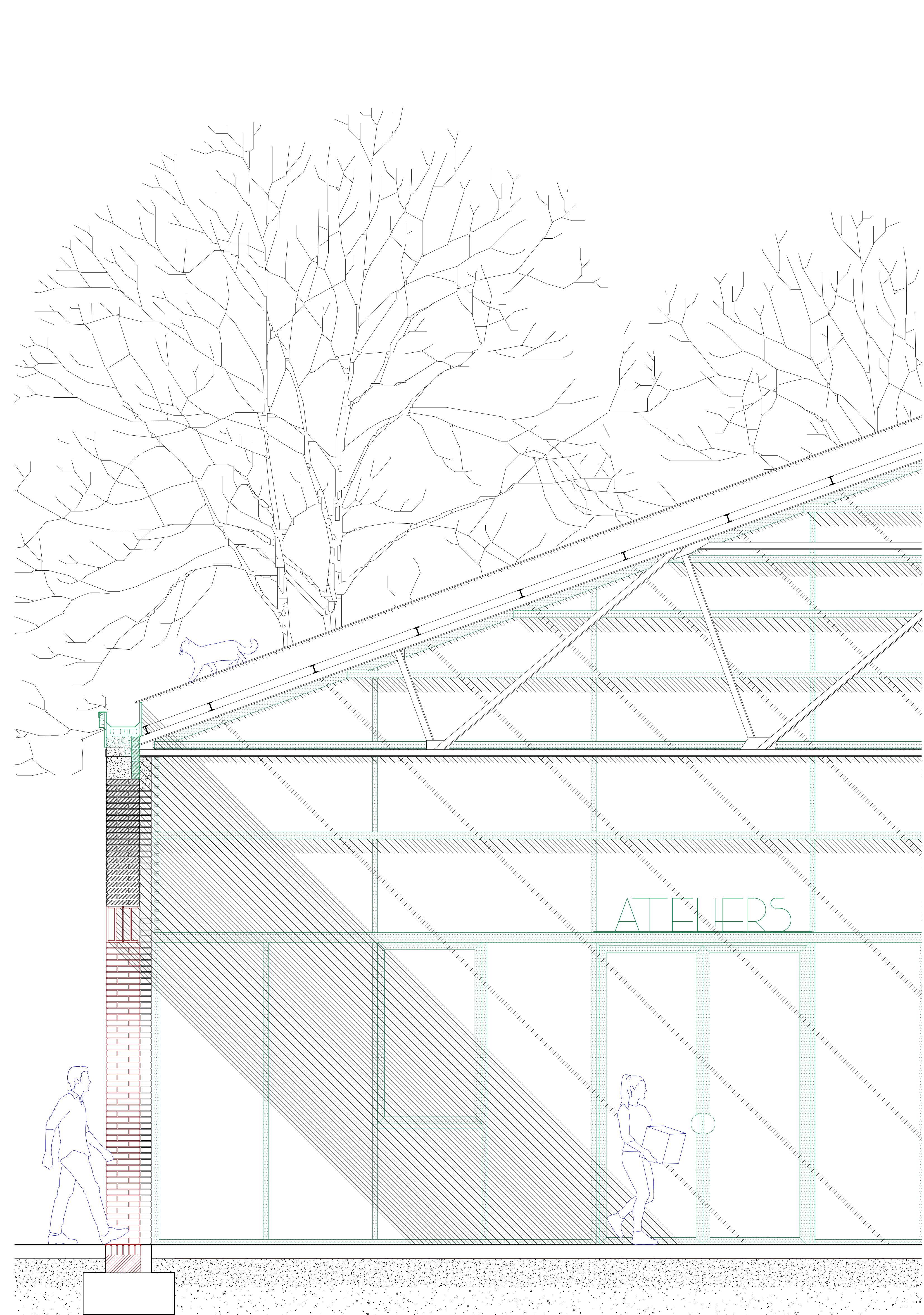

0 0.25 0.5 1m

Projet : coupe ateliers polyvalents
 Patrimoine enclavé : Occupation temporaire comme levier de réaffectation
 "LIBAIC" 2237 | Ateliers de recherches - Patrimoine hérité | 2022-2023
 GILLIS Christophe - VANDENBROUCKE David