

## Typologies des écoles du XIXe et XXe siècles

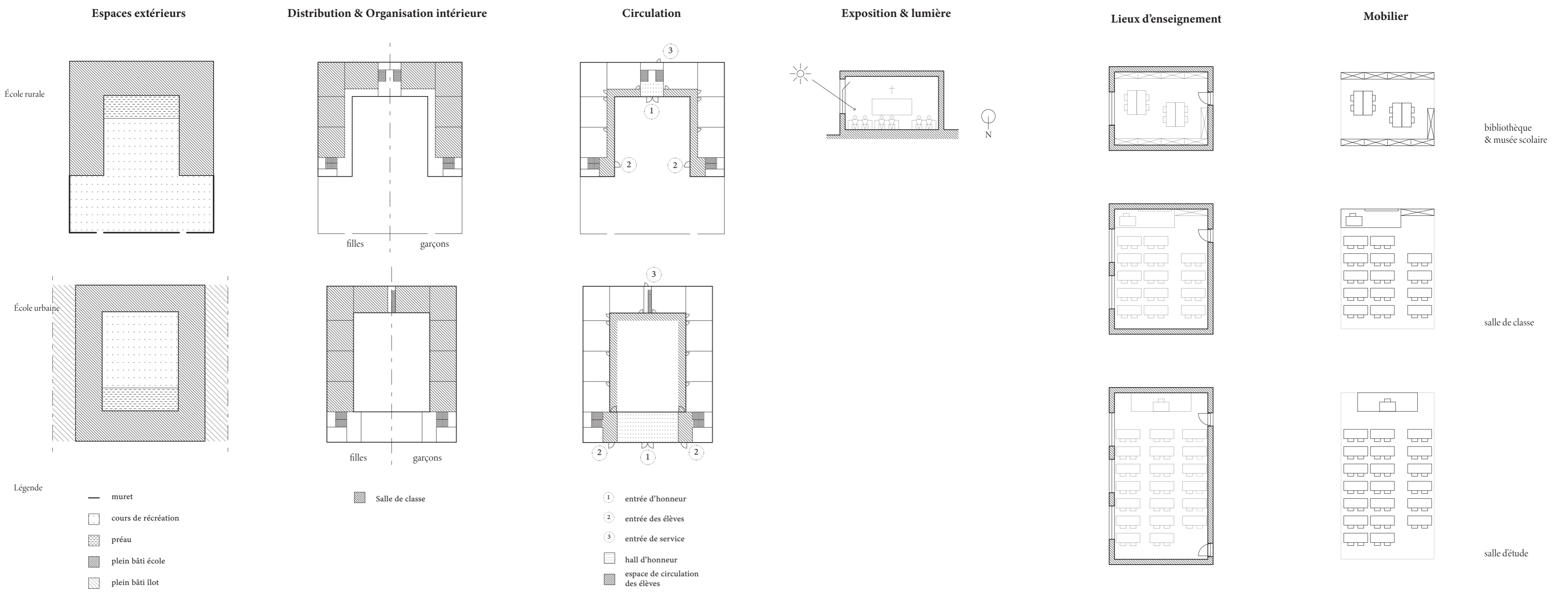

## Typologies des écoles actives

### Distribution & Organisation intérieure

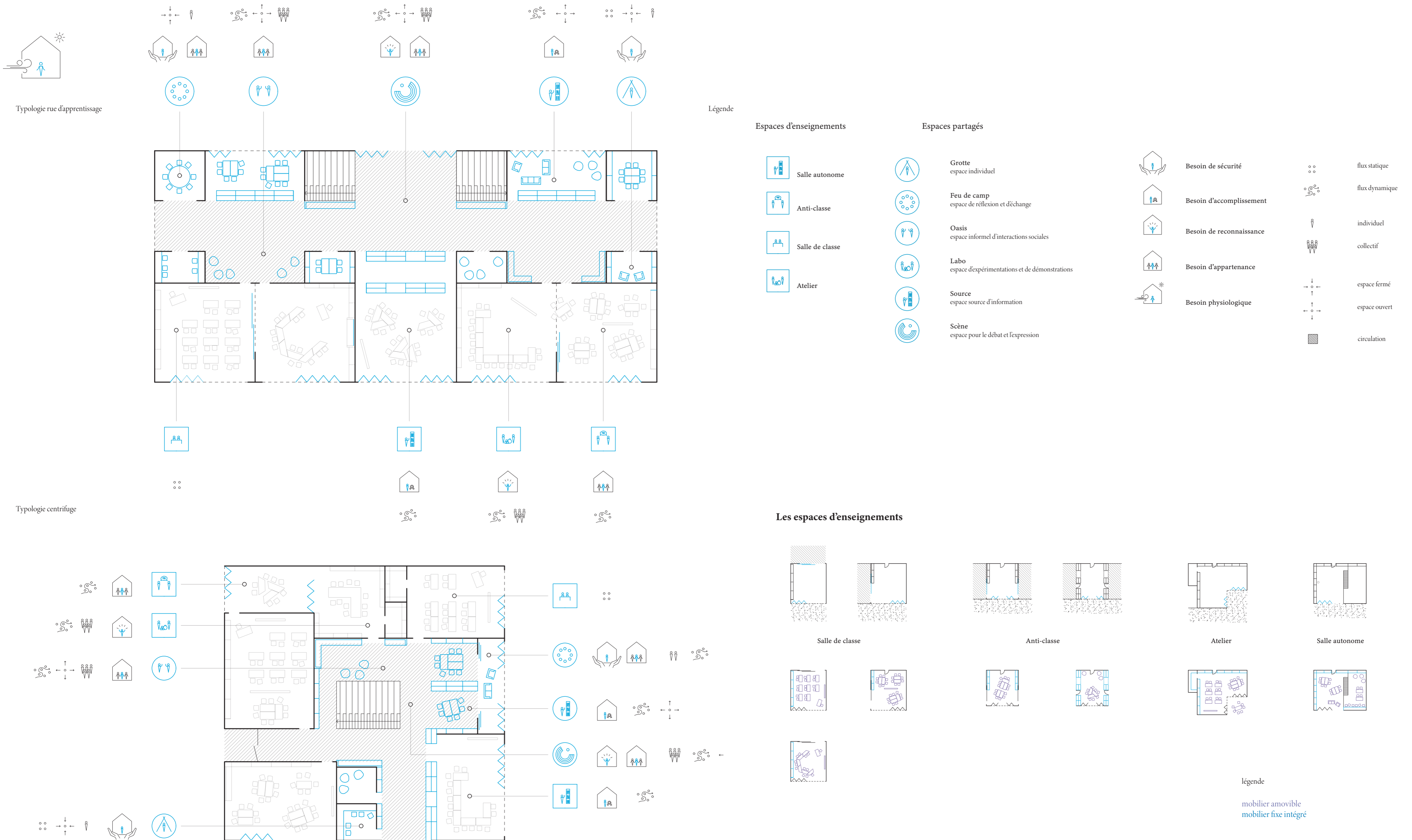

## Comparaison typologique

L'école aux XIXe et XXe siècles

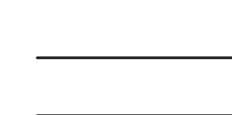
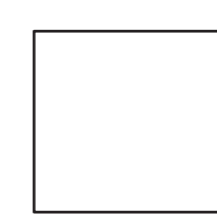
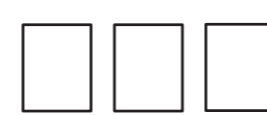
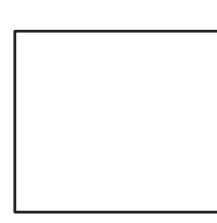

L'école Active

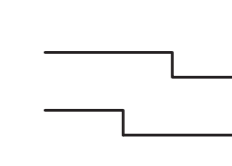
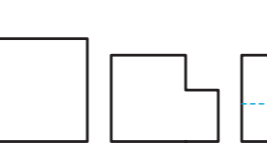
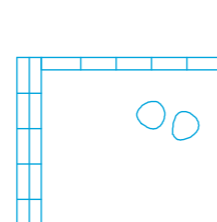
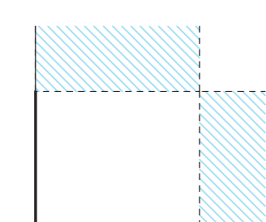

# ANALYSE HISTORIQUE - Le collège Saint-Michel

## Carte d'identité

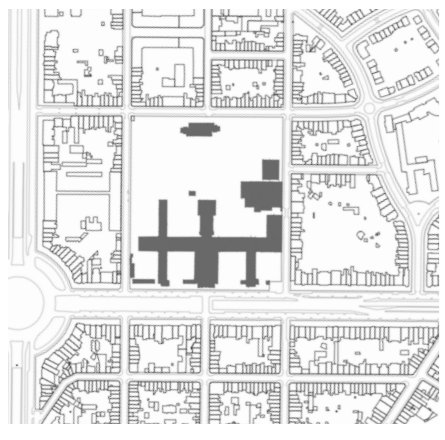

**Style** Eclectisme à dominance romane-néo-traditionnel  
**Architectes** Alphonse Gellée - Joseph Prémont  
**Année de construction** 1902  
**Fonction** Ecole primaire et secondaire  
**Type d'enseignement** Pédagogie jésuite  
**Adresse** 26 Boulevard Saint-Michel, 1040 Etterbeek, Bruxelles, Belgique

## Les trois collèges

Localisation : rue de la paille, rue Ruysbroeck, Bruxelles  
 Capacité : 500 et 600 élèves  
 Fonction actuelle : /

1502

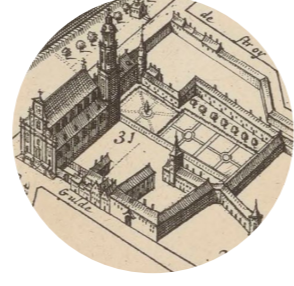

Localisation : 4 Rue des Ursulines, Bruxelles  
 Capacité : 1000 élèves  
 Actuellement : Collège Saint-Jean-Berchmans

1835



1905



Localisation : 24 Boulevard du Collège Saint-Michel, Etterbeek  
 Capacité : 1600 élèves  
 Actuellement : Collège Saint-Michel

## Évolution des bâtis

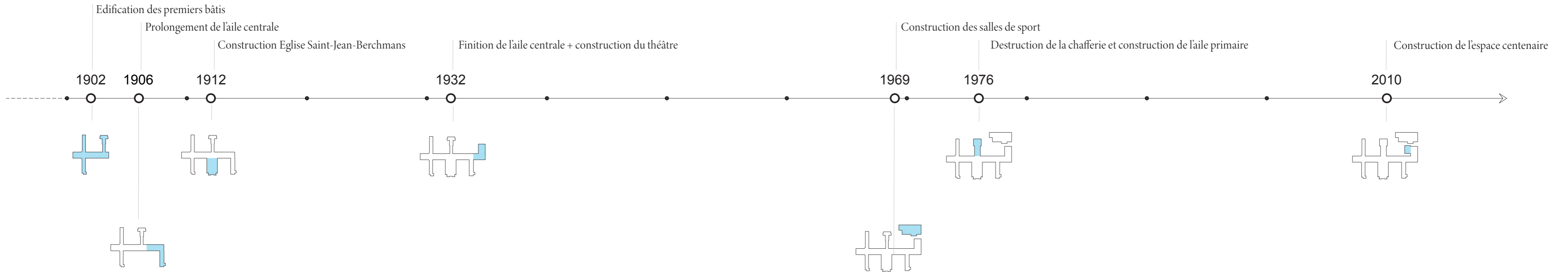

Coupe AA'

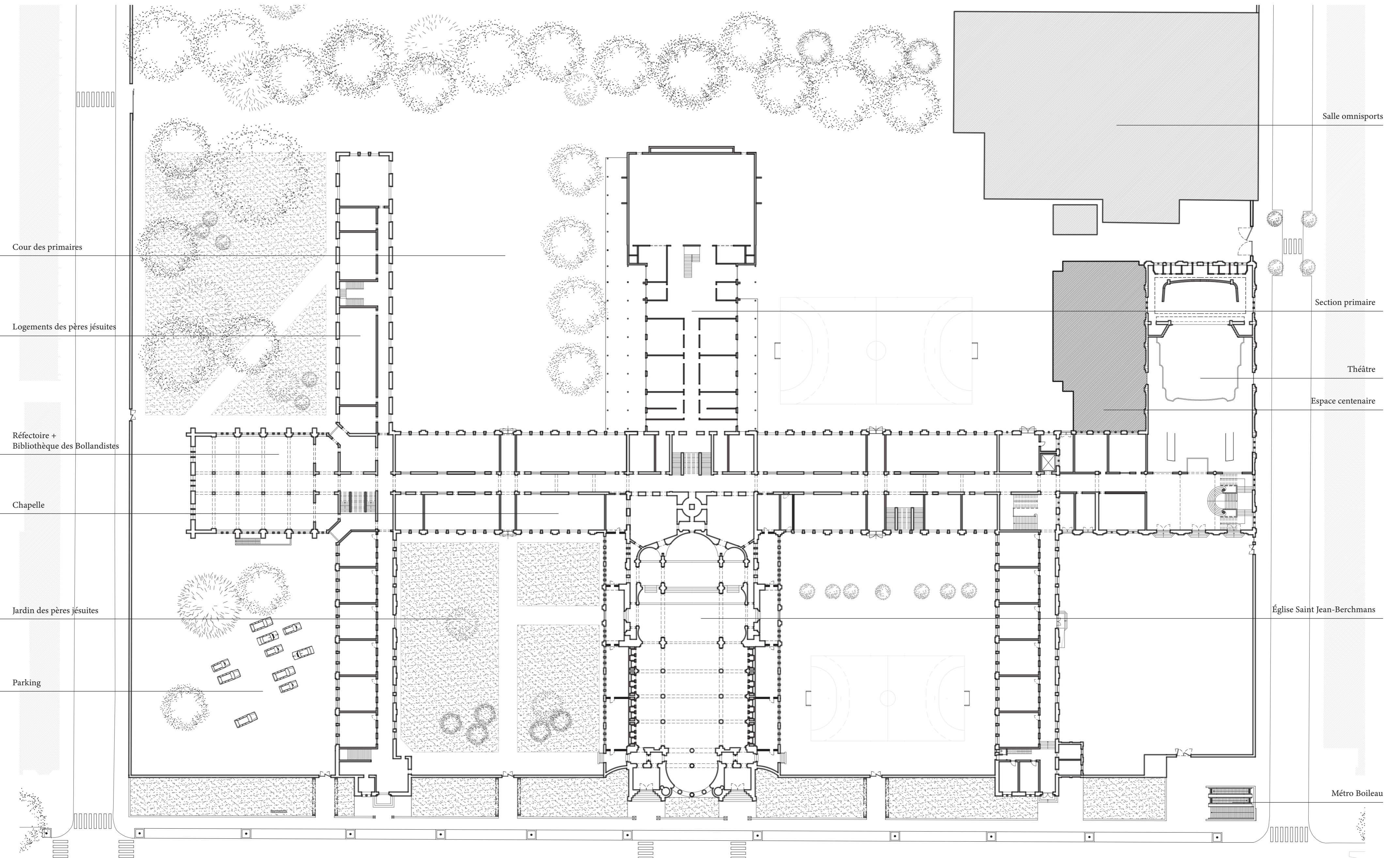

Plan du rez-de-chaussée

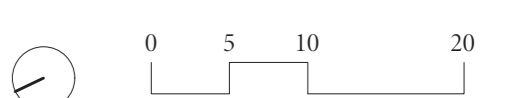

Les valeurs monumentales du Collège

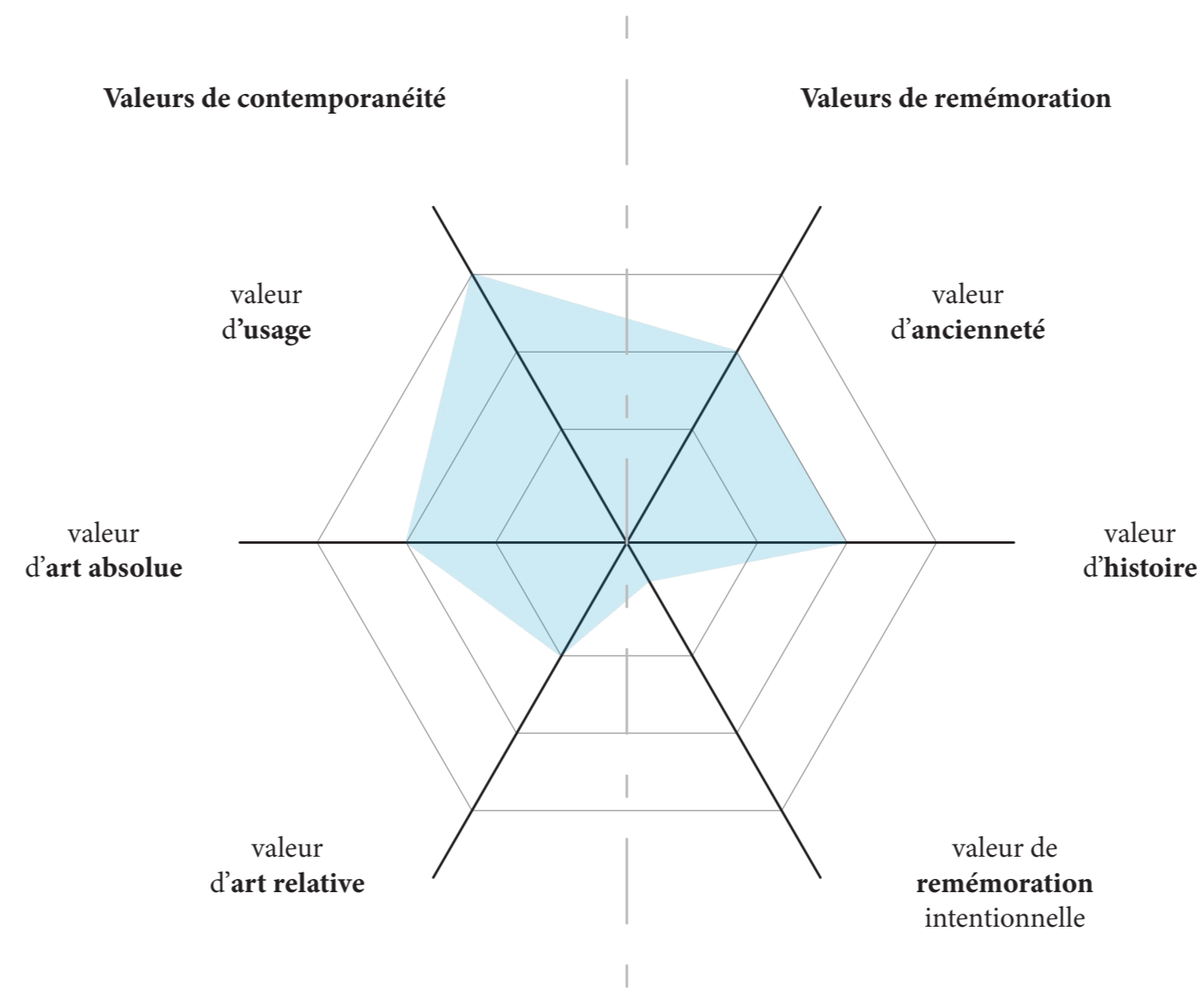

Potentiels du site

Obstacles

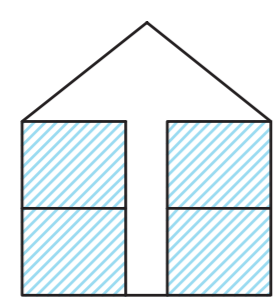

Homogénéité des espaces

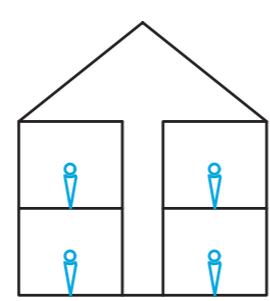

Espaces clos

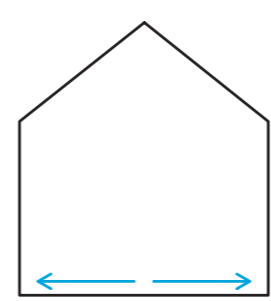

École et espaces scolaires fermés

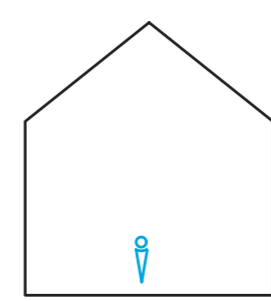

Espaces pauvres en mobilier

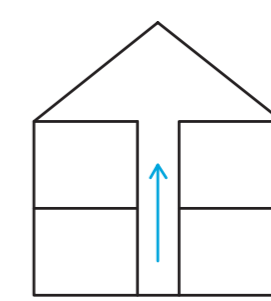

Espaces rigides

Opportunités

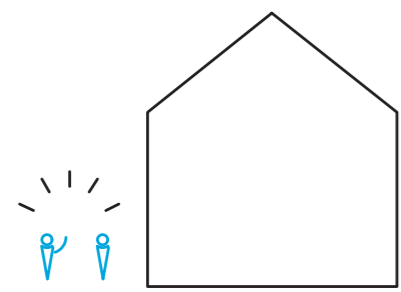

Quartier dynamique

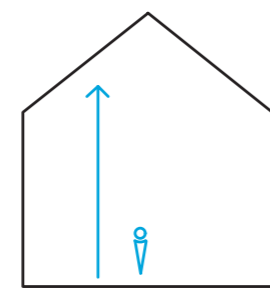

Grande hauteur sous plafond

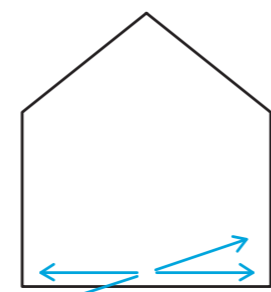

Surfaces généreuses

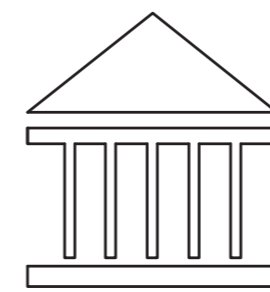

Valeurs monumentales

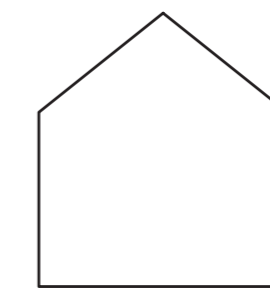

Éclairage naturel

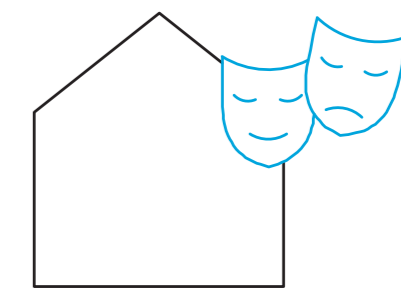

Structures culturelles

Projection programmatique & stratégies

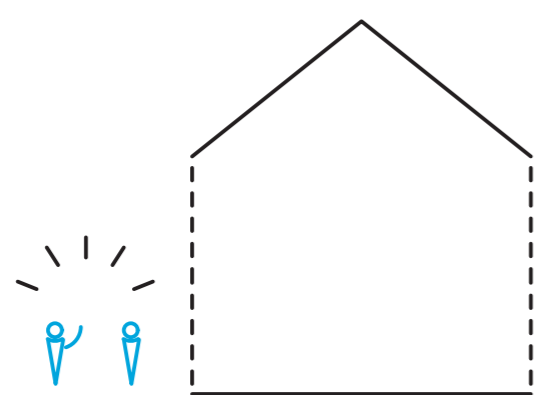

Ouverture sur le quartier

Aménagement de parvis  
articulation entre la ville et l'école

Création d'un centre culturel  
connection sociale de l'école à la ville

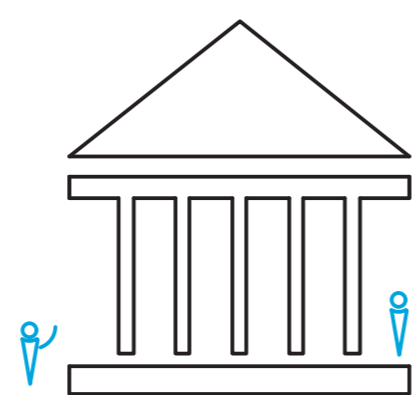

Concervation et renforcement des valeurs monumentales

Accès aux espaces patrimoniaux  
sensibilisation au patrimoine

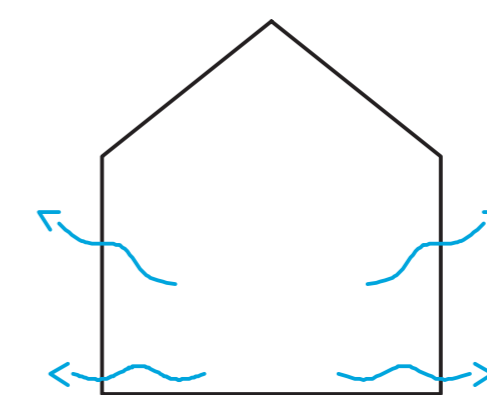

Assouplissement structurel

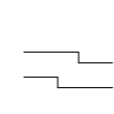

Déstructuration linéaire  
Flexibilisation des espaces

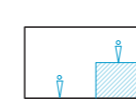

Utilisation de la hauteur  
aménagement de mezzanines

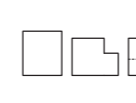

Diversification des espaces  
en fonction des divers besoins

Extension des espaces  
possibilité d'interconnexions

Aménagement de mobilier  
possibilité d'appropriation de l'espace

Porosité  
perforation des parois

Ouverture vers le quartier  
& Valorisation monumentale

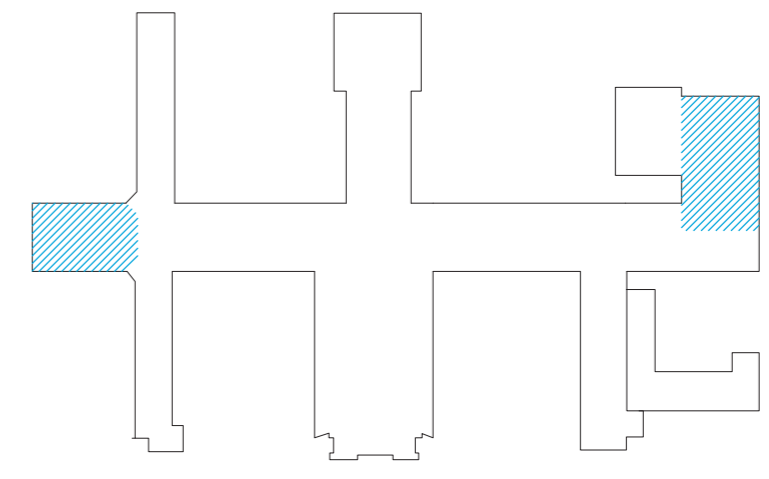
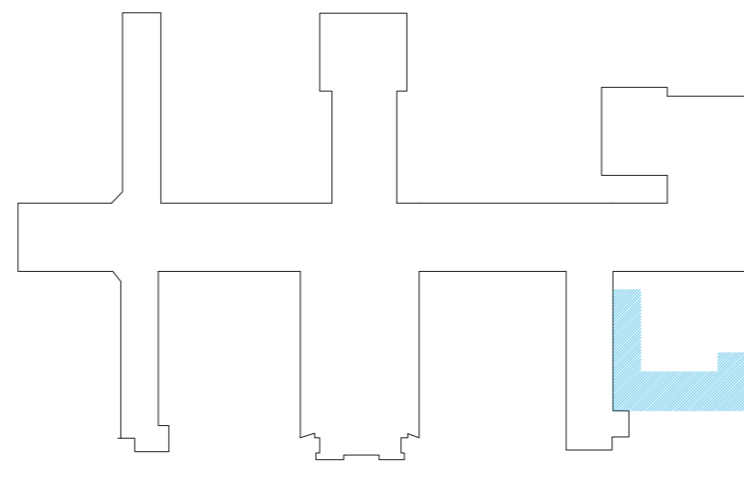
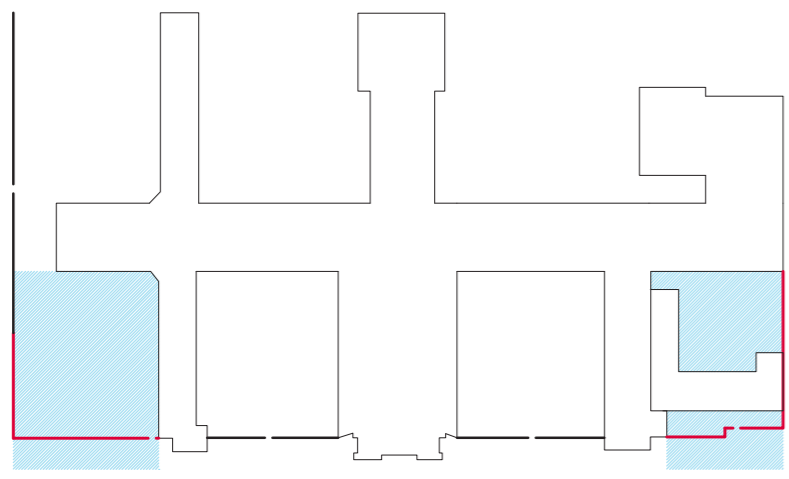

Aménagement de parvis

articulation entre  
la ville et l'école

Création d'un centre culturel

connection sociale  
de l'école à la ville

Accès aux espaces patrimoniaux

sensibilisation  
au patrimoine

Assouplissement structurel

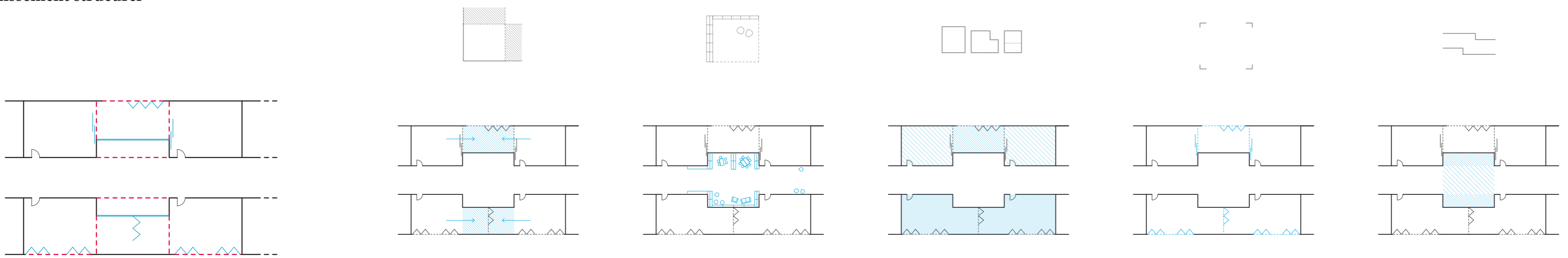

stratégie

Extension des espaces  
possibilité  
d'interconnexions

Aménagement de mobilier  
possibilité d'appropriation  
de l'espace

Diversification des espaces  
en fonction  
des divers besoins

Porosité  
perforation  
des parois

Déstructuration linéaire  
Flexibilisation  
des espaces

Projection conceptuelle  
sur le Collège Saint-Michel

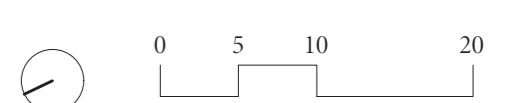
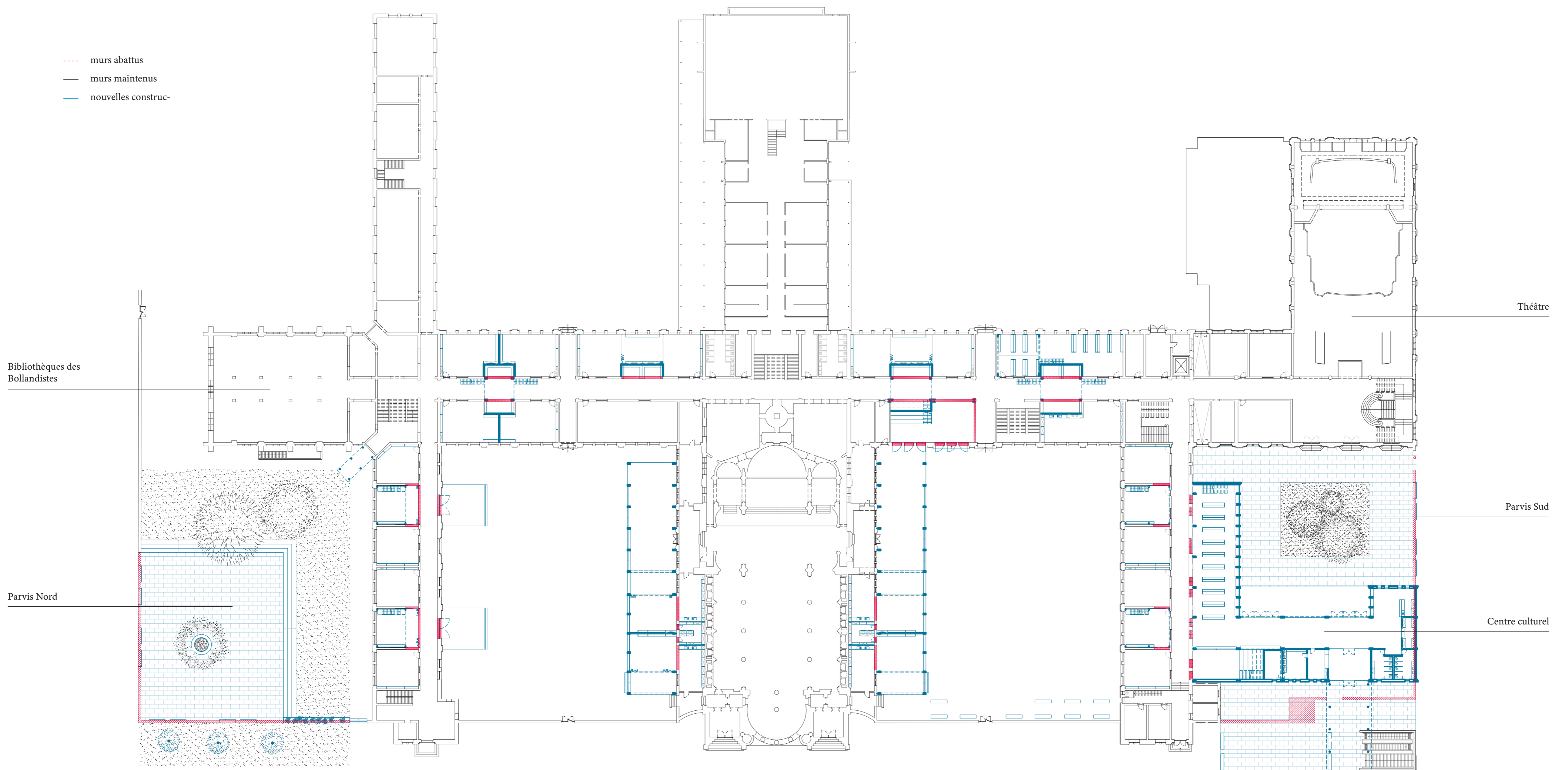



coupe AA'

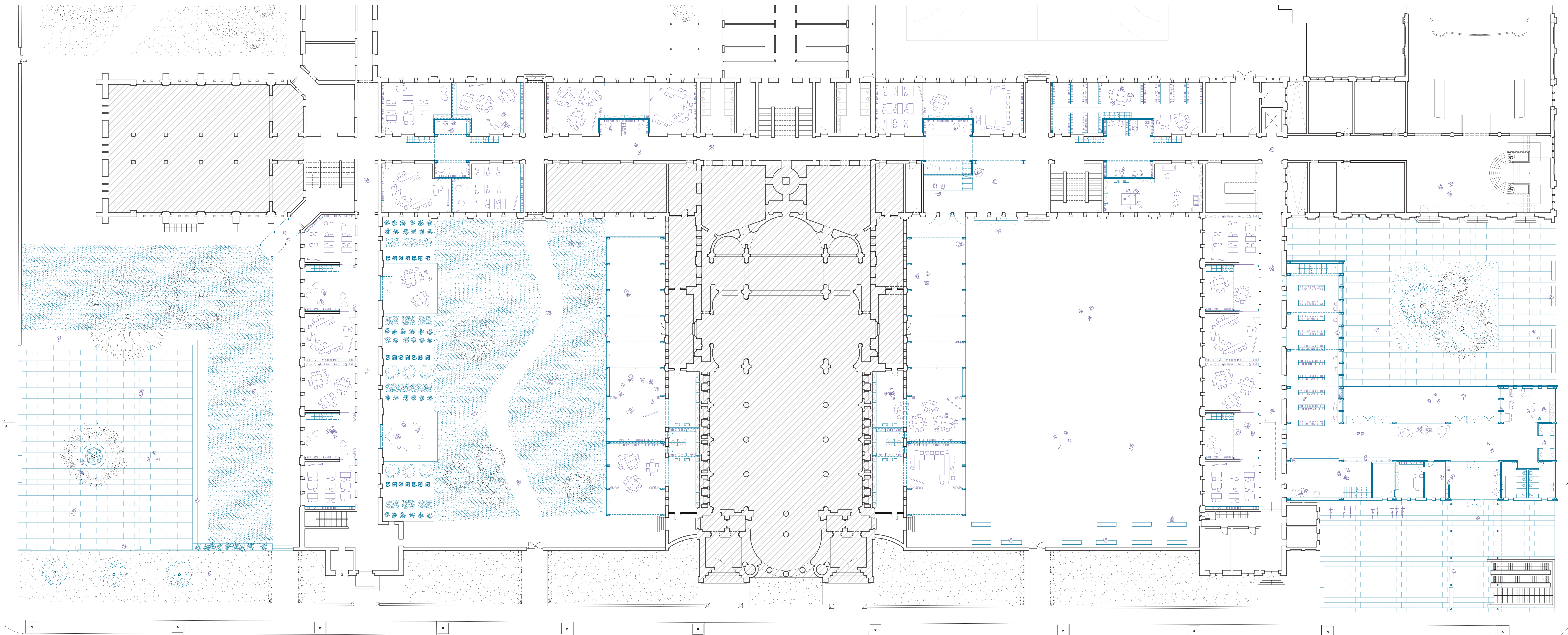

plan rez-de-chaussée

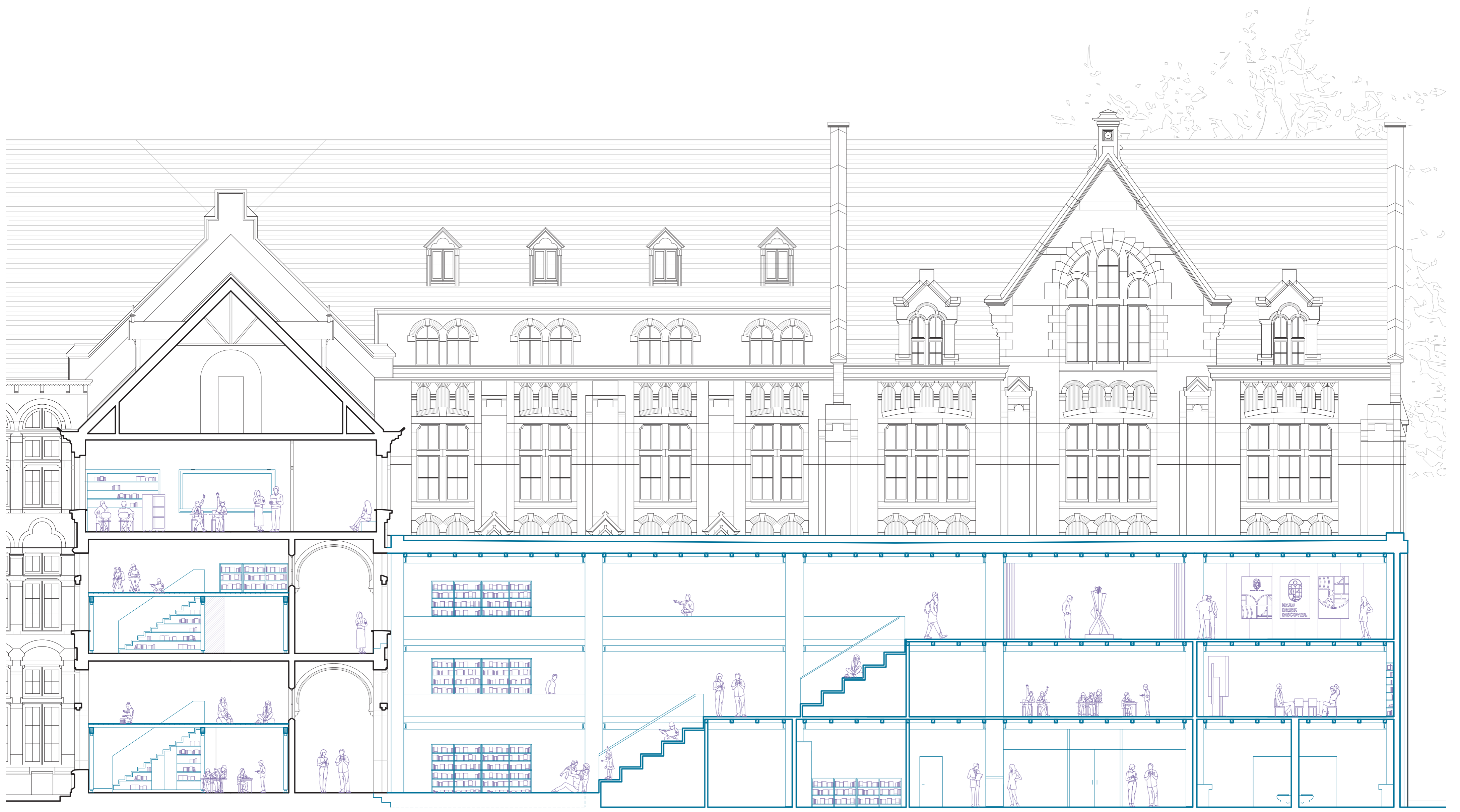

Coupe AA'

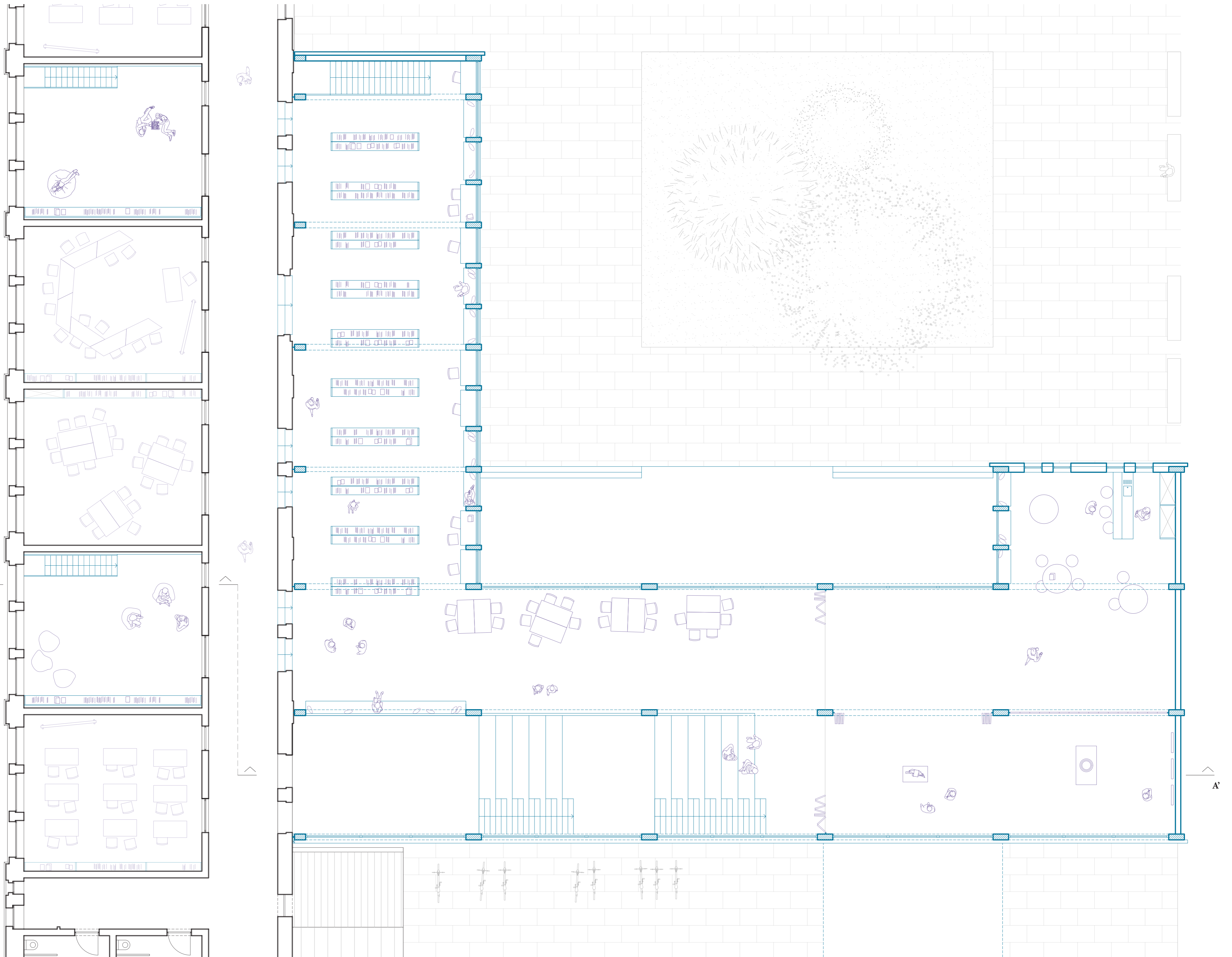

Plan R+2

Espaces d'enseignements

- Extension de l'espace
- mobilier fixe
- mobilier amovible

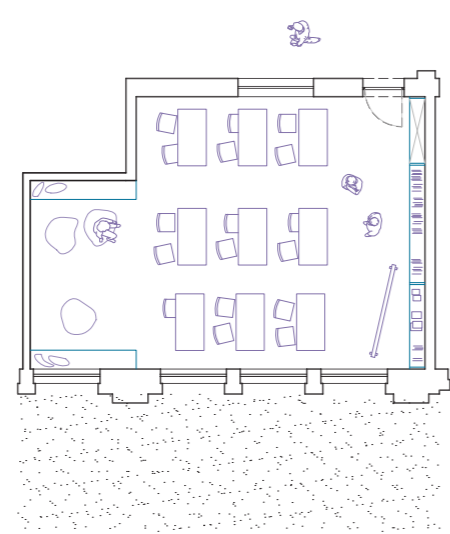

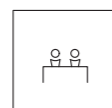
 Salle de classe enseignement transmissif

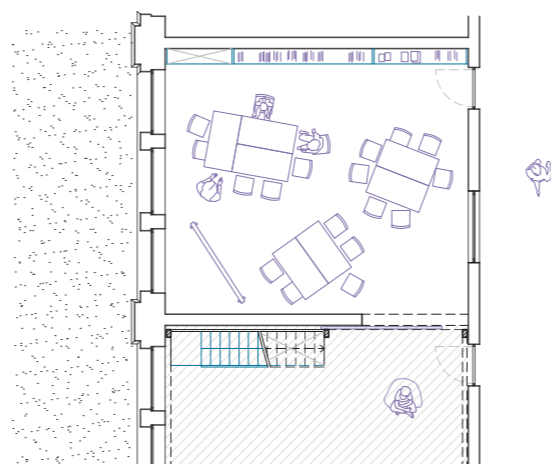

 Salle de classe enseignement collectif

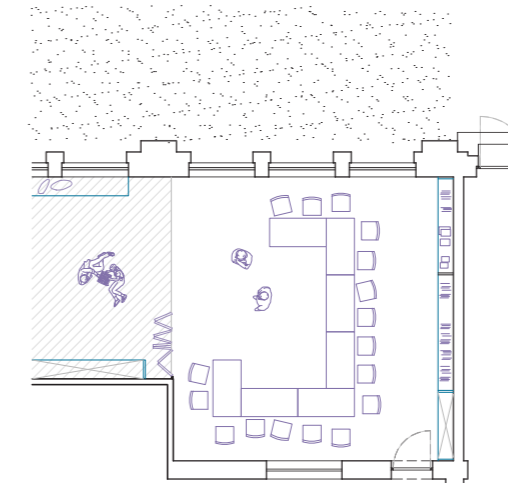

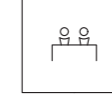
 Salle de classe enseignement expérimentiel

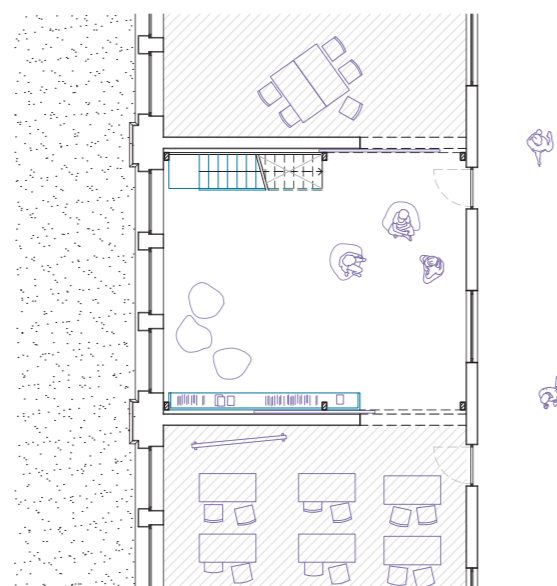

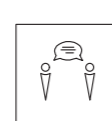
 Anti-classe enseignement collectif enseignement autonome

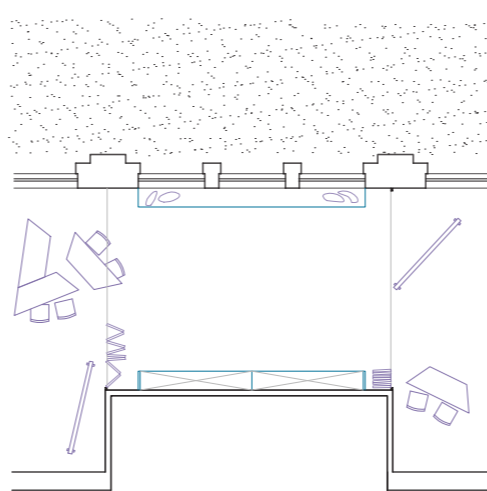

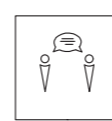
 Anti-classe enseignement collectif enseignement autonome

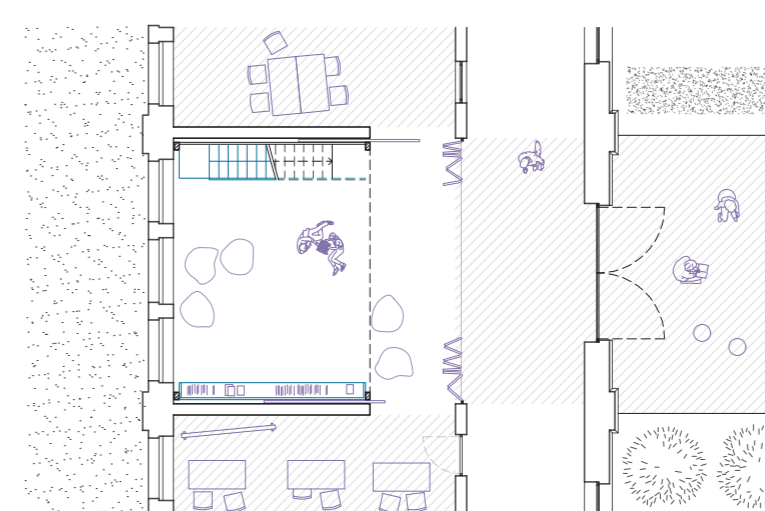

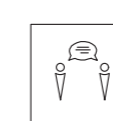
 Anti-classe enseignement collectif enseignement autonome



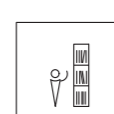

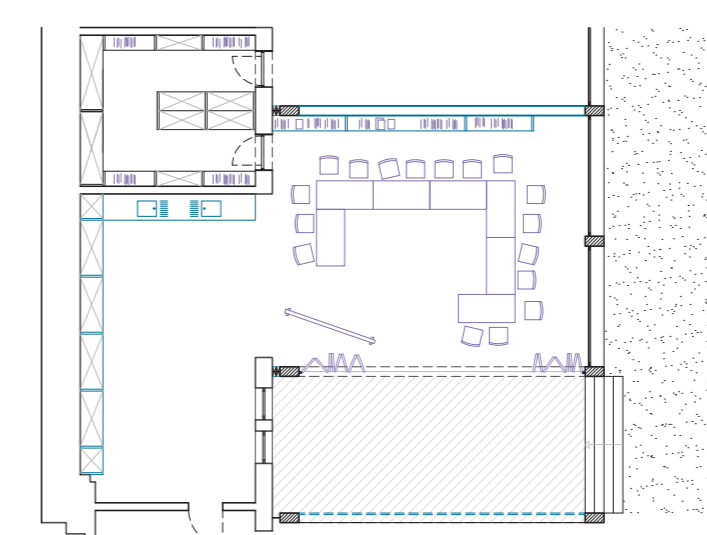
 Salle autonome enseignement autonome enseignement collectif

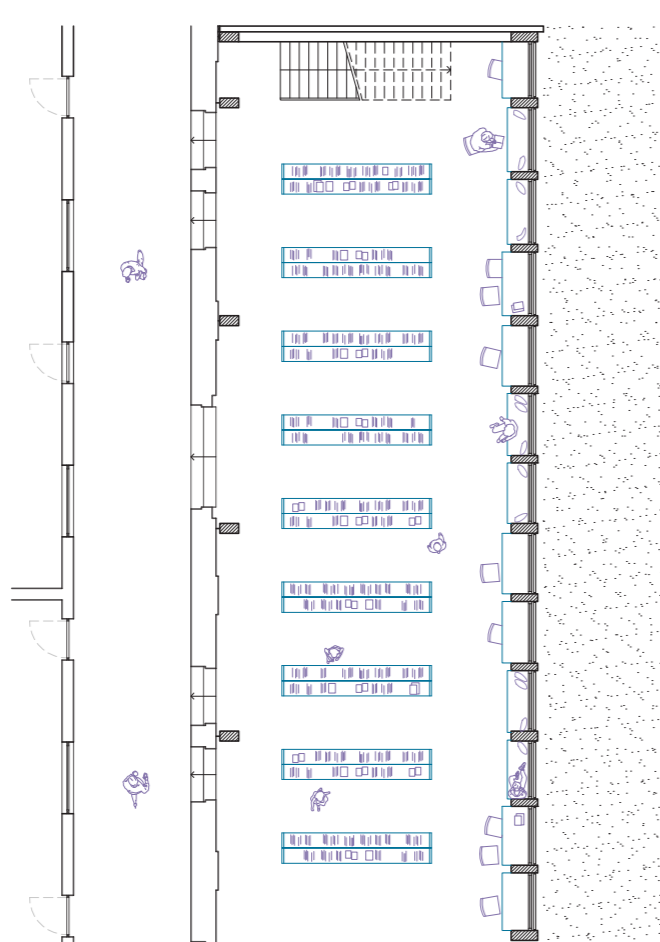

 Atelier enseignement expérimentiel enseignement collectif

Espaces partagés



 Source Espace source d'information et documentations

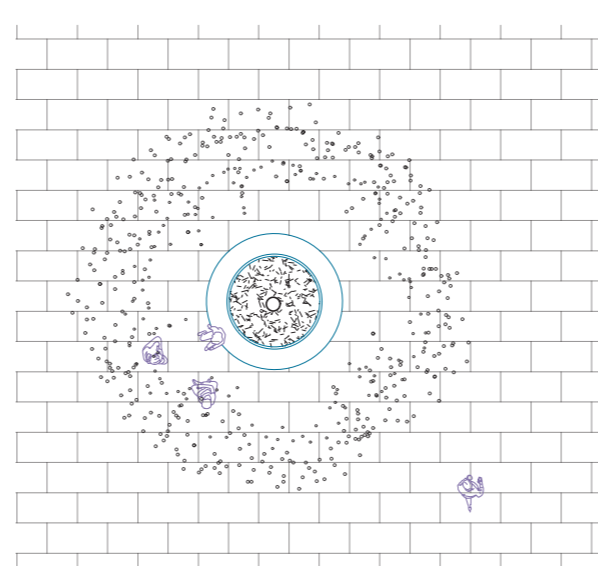

 Oasis Espace de rencontres informelles

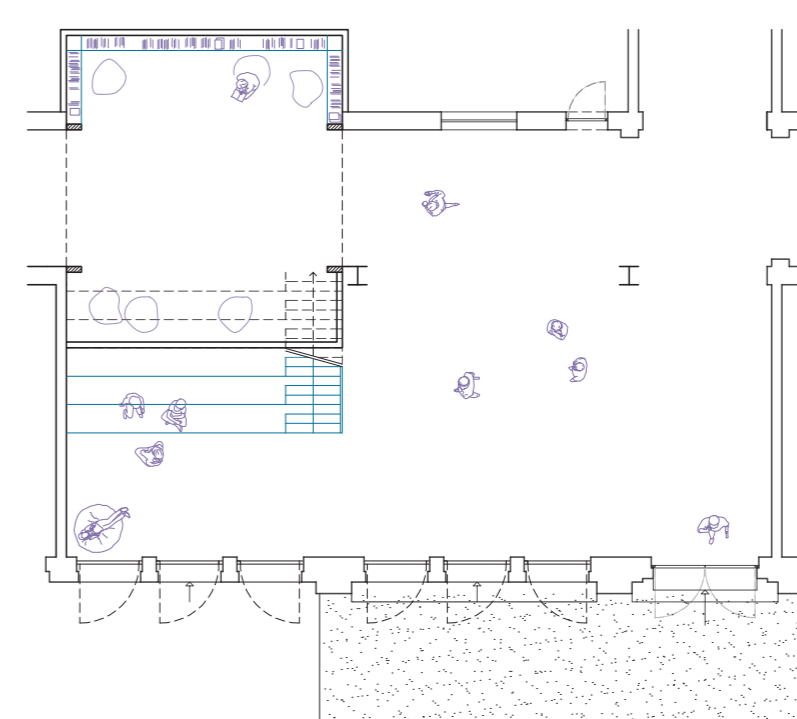

 Scène Espace de débat, forum étudiant



 Grotte Espace individuel

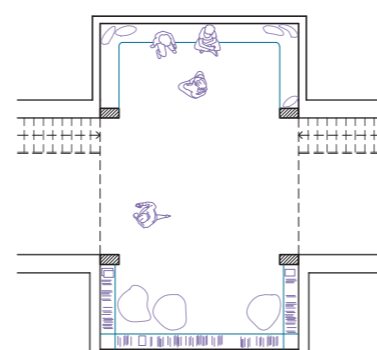

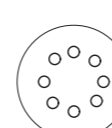
 Feu de camp Espace de réflexion et d'échange en petit groupe

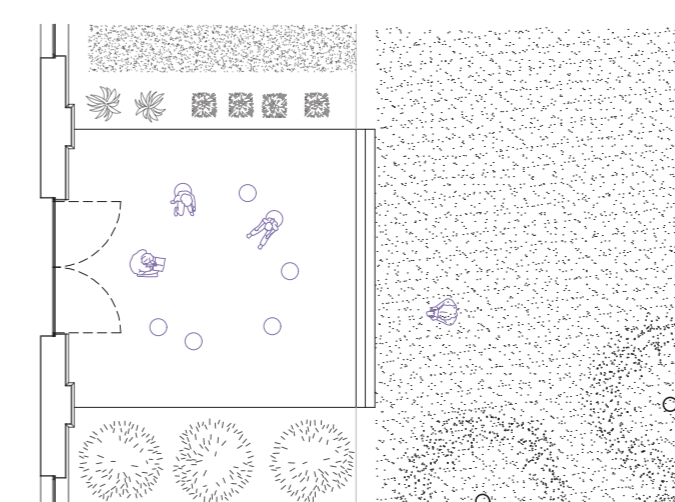

 Labo Espace d'expérimentation et de démonstration

